

AWAKiF

SERVICE MANUAL

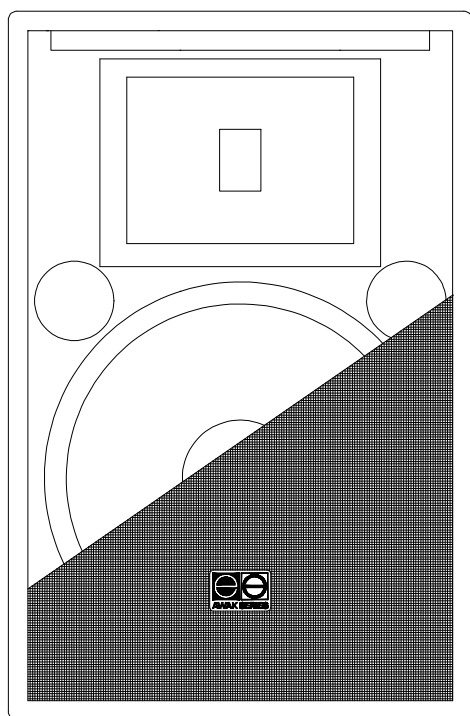

AWAK112iF

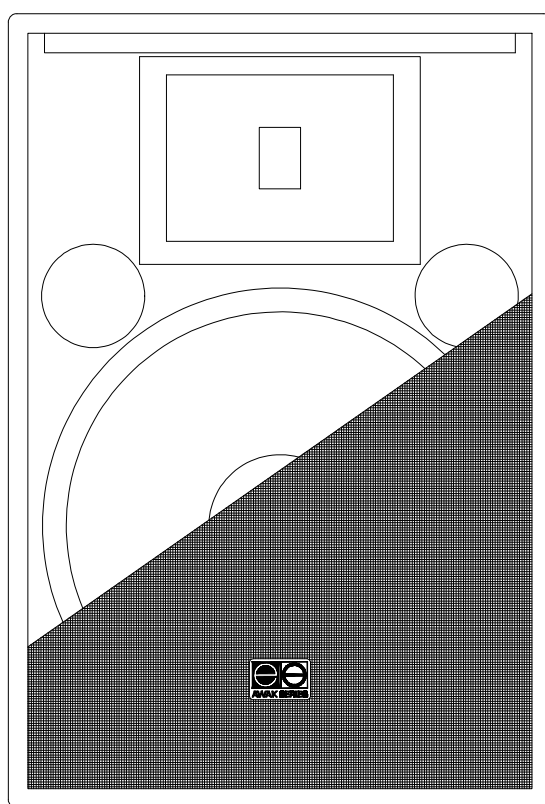

AWAK115iF

ECLEREO

AUDIO CREATIVE POWER

INDEX

- AWAK112iF

Schema

Components location schema

Wiring diagram

Mechanical diagram

Packing diagram

- AWAK115iF

Schema

Components location schema

Wiring diagram

Mechanical diagram

Packing diagram

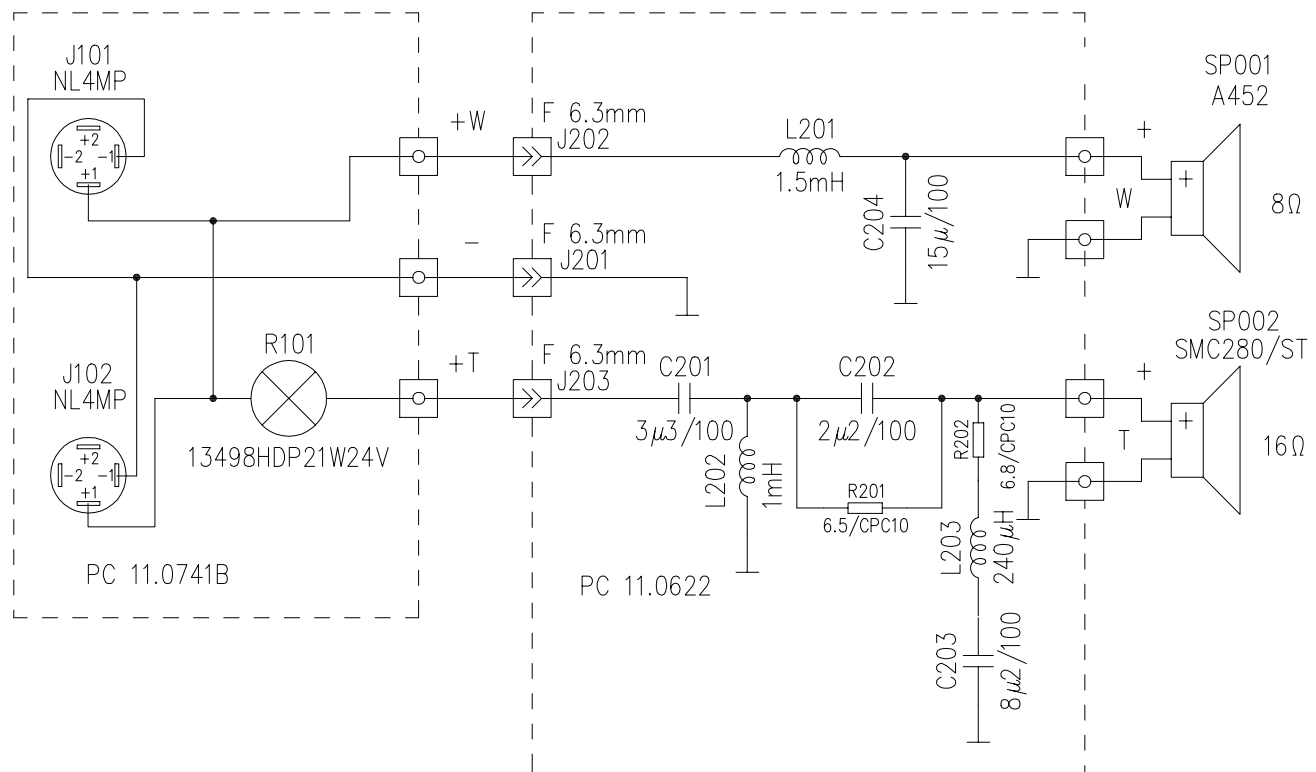

All capacitors 63 V. unless otherwise noted.
 Resistors in Ohms. Capacitors in Farads. Inductors in Henries.
 All resistors 1/4 W. unless otherwise noted.
 See parts list for more information about components.

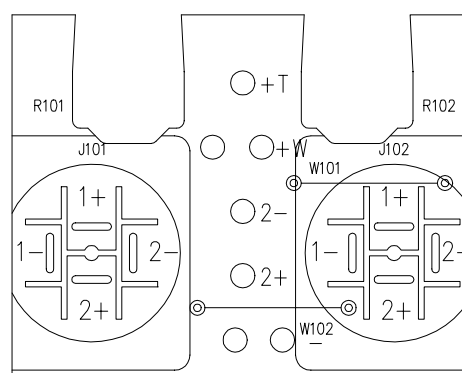

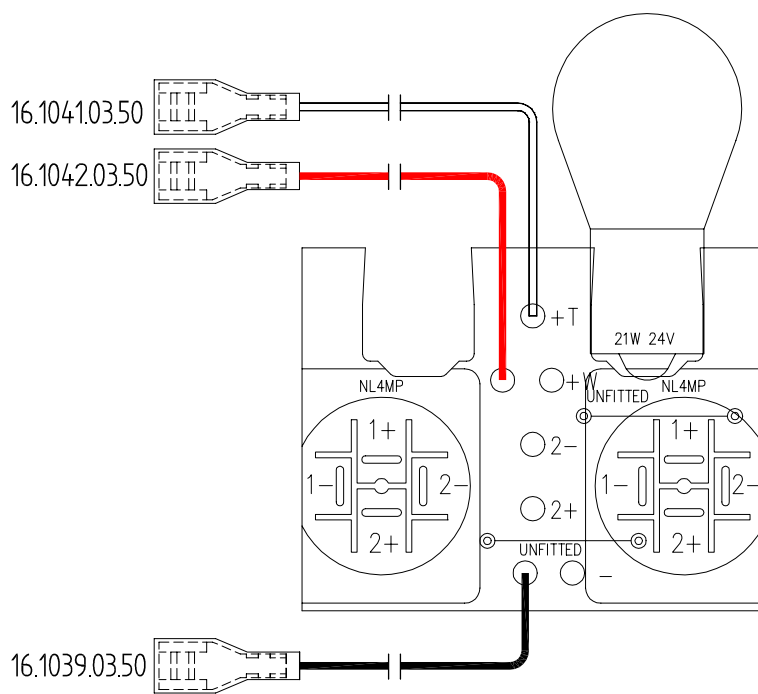

PARTS LIST: PRINTED CIRCUIT 11.0741B

Code	Description	Reference
FCCI074100	Print board 11.0741B	
FCBASS0100	SPEAK-ON NL4MP FASTON	J101
FCBASS0100	SPEAK-ON NL4MP FASTON	J102
FCBM024210	LAMP 24V 21W.	R101
FC0H039350	WIRE 16.1039.03.50	
FC0H041350	WIRE 16.1041.03.50	
FC0H042350	WIRE 16.1042.03.50	

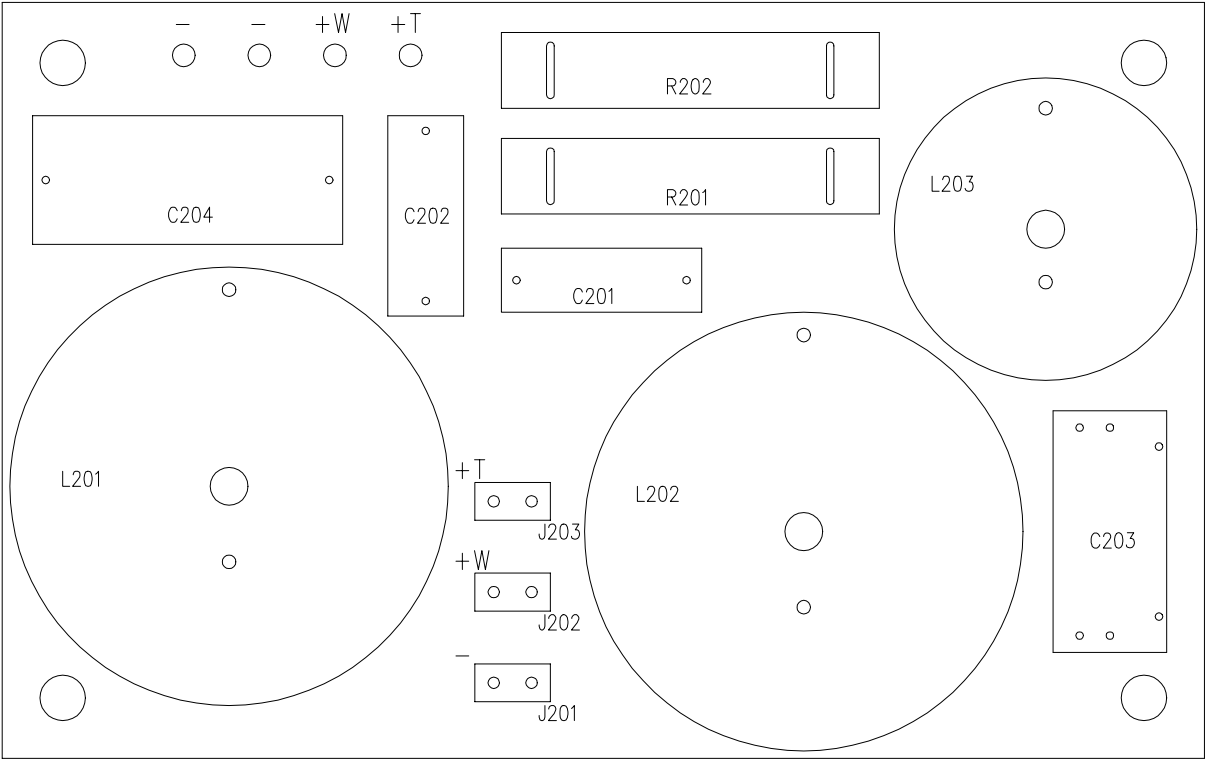

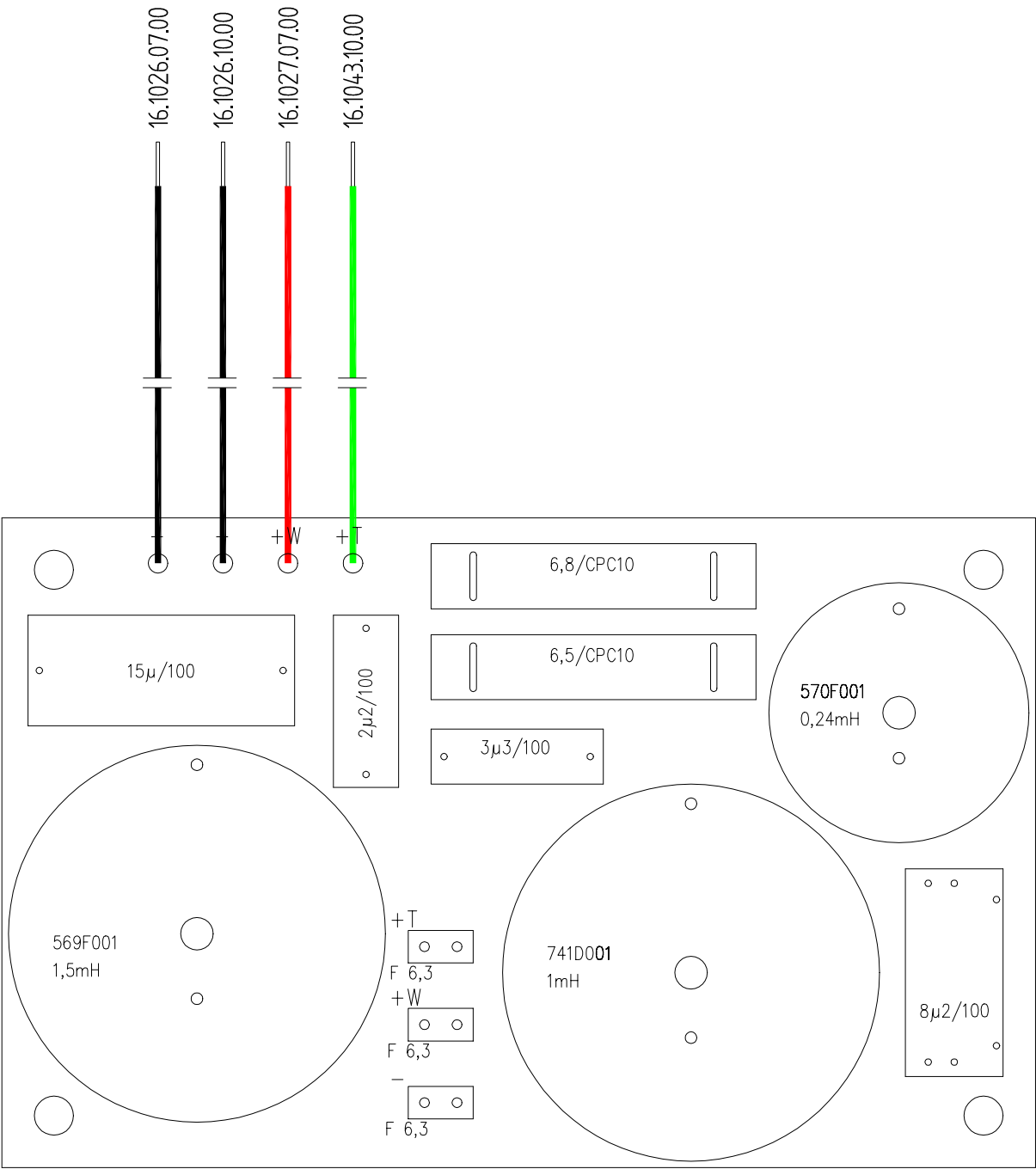

IMPORTANT NOTES:
- Apply Clear Silicone Sealant in all the capacitors.
- The three coils must be riveted.

ECLEREE

drawn: *J. Colomines*
approved:

date: *03/2/17*
title:

project:

C16-02

product:

AWAK112iF

number: *33.0829* version: *01.01*

11.0622 Value

PARTS LIST: PRINTED CIRCUIT 11.0622

Code	Description	Reference
FCCDR10033	CONDEN.CMR 5% 3,3mF100v R-22.5	C201
FCCDR10022	CONDEN.CMR 5% 2.2uF100v R-22.5	C202
FCCDR10015	COND.CMR 5% 1,5uF 100V R-22.5	C203
FCCDR10068	COND.CMR 5% 6.8uF 100V R-27.5	C203
FCCDR10150	CONDEN.CMR 5% 15uF100v R-37.5	C204
FCTERMF630	FASTON 6,3mm	J201
FCTERMF630	FASTON 6,3mm	J202
FCTERMF630	FASTON 6,3mm	J203
FCBB000250	BOBINA 1.5mH 1.2mm 569F001	L201
FCBB000700	BOBINA 1 mH 1 mm 741D001	L202
FCBB000260	BOBINA 240micH 1mm 570F001	L203
FCRYD01550	RESIS.BOB.6.5 ohm CPC10 10w 5%	R201
FCRYD01552	RESIS.BOBI.6.8ohm CPC10 10w 5%	R202
FCCIFLT030	C.I.FR4 35mC 11.0622 FILT.FRA	
FC0H026700	WIRE 16.1026.07.00	
FC0H027700	WIRE 16.1027.07.00	
FC7H026000	WIRE 16.1026.10.00	
FC7H043000	WIRE 16.1043.10.00	

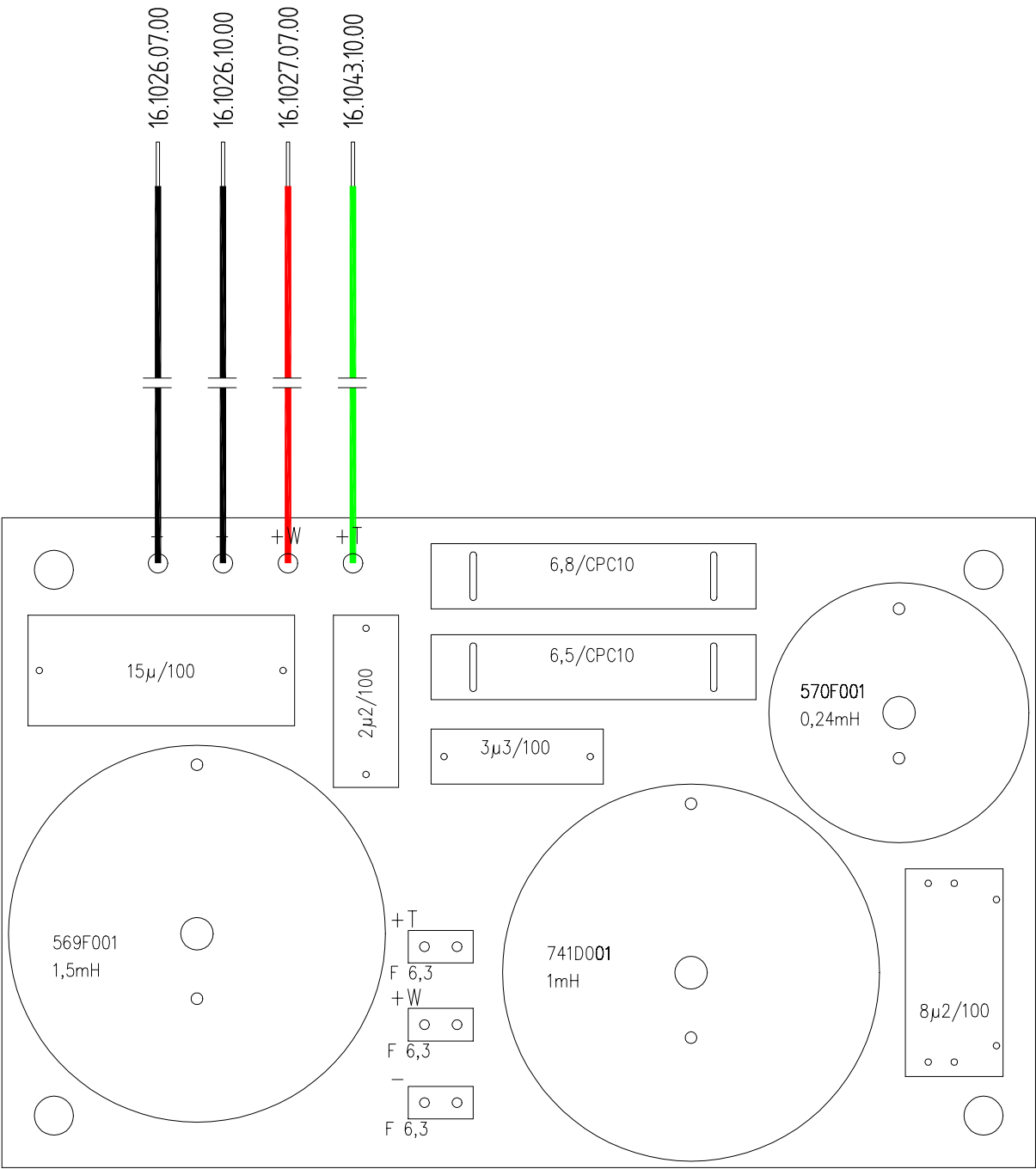

OLD VERSION

ECLEREE

drawn: J. Colomines
approved:

date: 02/03/0
title:

project:

C16-02

product:

AWAK112iF

number: 33.0829
version: 01.00

11.0622 Valors

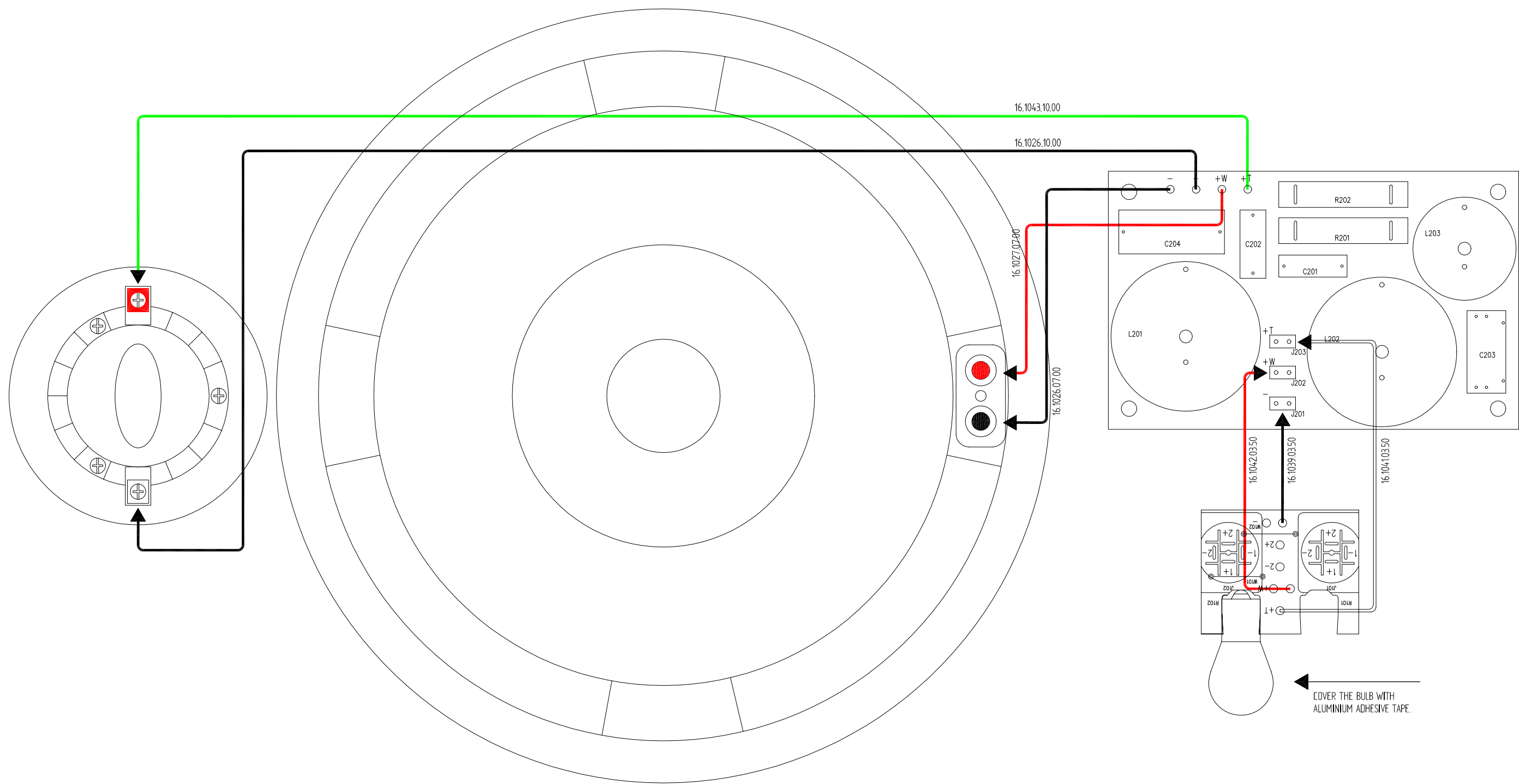

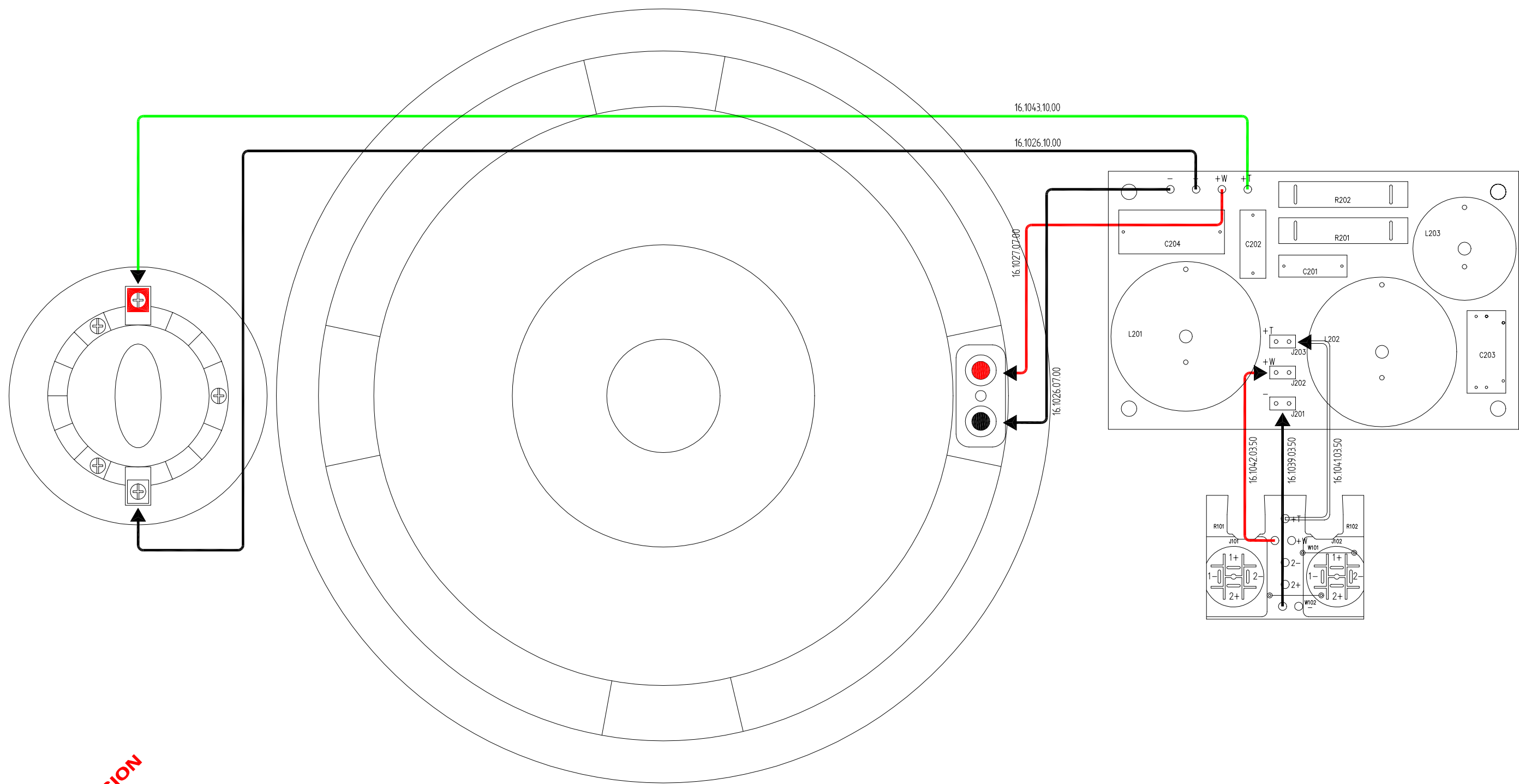

OLD VERSION



drawn: J. Colomines

date: 02/03/0

project:

C16-02

product:

AWAK112iF

approved:

title:

WIRING DIAGRAM

number: 31.0178 version 01.00

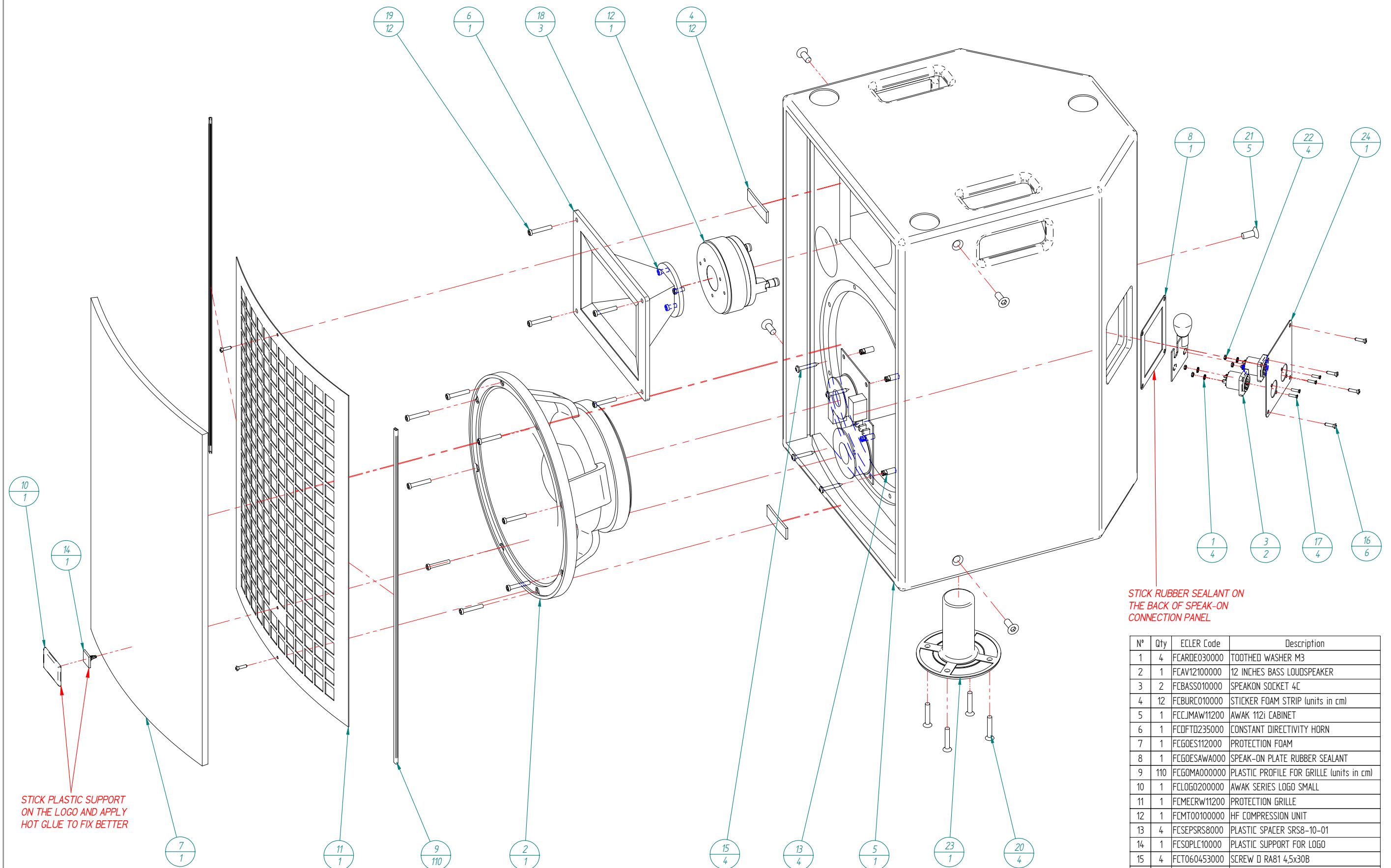

N°	Qty	ECLER Code	Description
1	4	FCARDE030000	TOOTHED WASHER M3
2	1	FCAV12100000	12 INCHES BASS LOUDSPEAKER
3	2	FCBASS010000	SPEAKON SOCKET 4C
4	12	FCBURC010000	STICKER FOAM STRIP (units in cm)
5	1	FCCJMAW11200	AWAK 112i CABINET
6	1	FCDFD235000	CONSTANT DIRECTIVITY HORN
7	1	FCGOES112000	PROTECTION FOAM
8	1	FCGOESAWA000	SPEAK-ON PLATE RUBBER SEALANT
9	110	FCGOMA000000	PLASTIC PROFILE FOR GRILLE (units in cm)
10	1	FCLOGO200000	AWAK SERIES LOGO SMALL
11	1	FCMECRW11200	PROTECTION GRILLE
12	1	FCMT00100000	HF COMPRESSION UNIT
13	4	FCSEPSRS8000	PLASTIC SPACER SRS8-10-01
14	1	FCSOPLC10000	PLASTIC SUPPORT FOR LOGO
15	4	FCT060453000	SCREW D RA81 4,5x30B
16	6	FCT070351700	SCREW DIN RA83 3,5x17B
17	4	FCT350301200	SCREW DIN966 M3x12
18	3	FCTALL512000	SCREW DIN912 M5x12 ALLEN
19	12	FCTALL530000	SCREW DIN912 M5X30
20	4	FCTALL635000	SCREW DIN7991 M6x35 ALLEN
21	5	FCTALL820000	SCREW D7991 M8x20 ALLEN
22	4	FCTUE0030000	NUT M3
23	1	FCVASELD00000	FLANGE FOR LOUDSPEAKER BOX
24	1	FP0274000000	SPEAK-ON CONNECTION PANEL

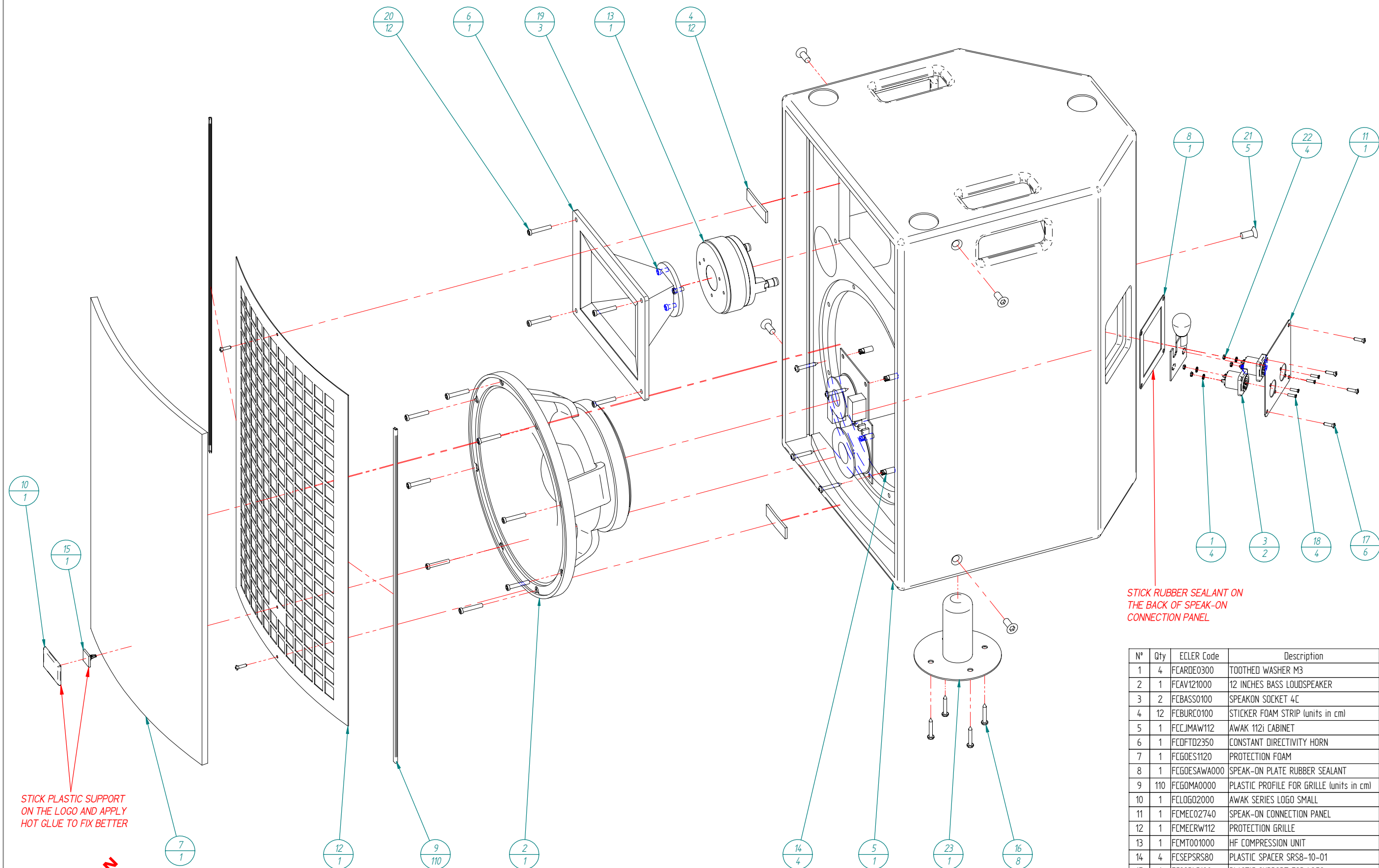

OLD VERSION

Nº	Qty	ECLER Code	Description
1	4	FCARDE0300	TOOTHED WASHER M3
2	1	FCAV121000	12 INCHES BASS LOUDSPEAKER
3	2	FCBASS0100	SPEAKON SOCKET 4C
4	12	FCBURC0100	STICKER FOAM STRIP (units in cm)
5	1	FCCJMAW112	AWAK 112i CABINET
6	1	FCDFD02350	CONSTANT DIRECTIVITY HORN
7	1	FCGOES1120	PROTECTION FOAM
8	1	FCGOESAWA000	SPEAK-ON PLATE RUBBER SEALANT
9	110	FCGOMA0000	PLASTIC PROFILE FOR GRILLE (units in cm)
10	1	FCLOGO2000	AWAK SERIES LOGO SMALL
11	1	FCMEC02740	SPEAK-ON CONNECTION PANEL
12	1	FCMECRW112	PROTECTION GRILLE
13	1	FCMT001000	HF COMPRESSION UNIT
14	4	FCSEPSRS80	PLASTIC SPACER SRS8-10-01
15	1	FCSOPLC100	PLASTIC SUPPORT FOR LOGO
16	8	FCT0604530	SCREW D RA81 4,5x30B
17	6	FCT0703517	SCREW DIN RA83 3,5x17B
18	4	FCT3503012	SCREW DIN966 M3x12
19	3	FCTALL5120	SCREW DIN912 M5x12 ALLEN
20	12	FCTALL5300	SCREW DIN912 M5x30
21	5	FCTALL8200	SCREW D7991 M8x20 ALLEN
22	4	FCTUE00300	NUT M3
23	1	FCVASTH400	FLANGE FOR LOUDSPEAKER BOX

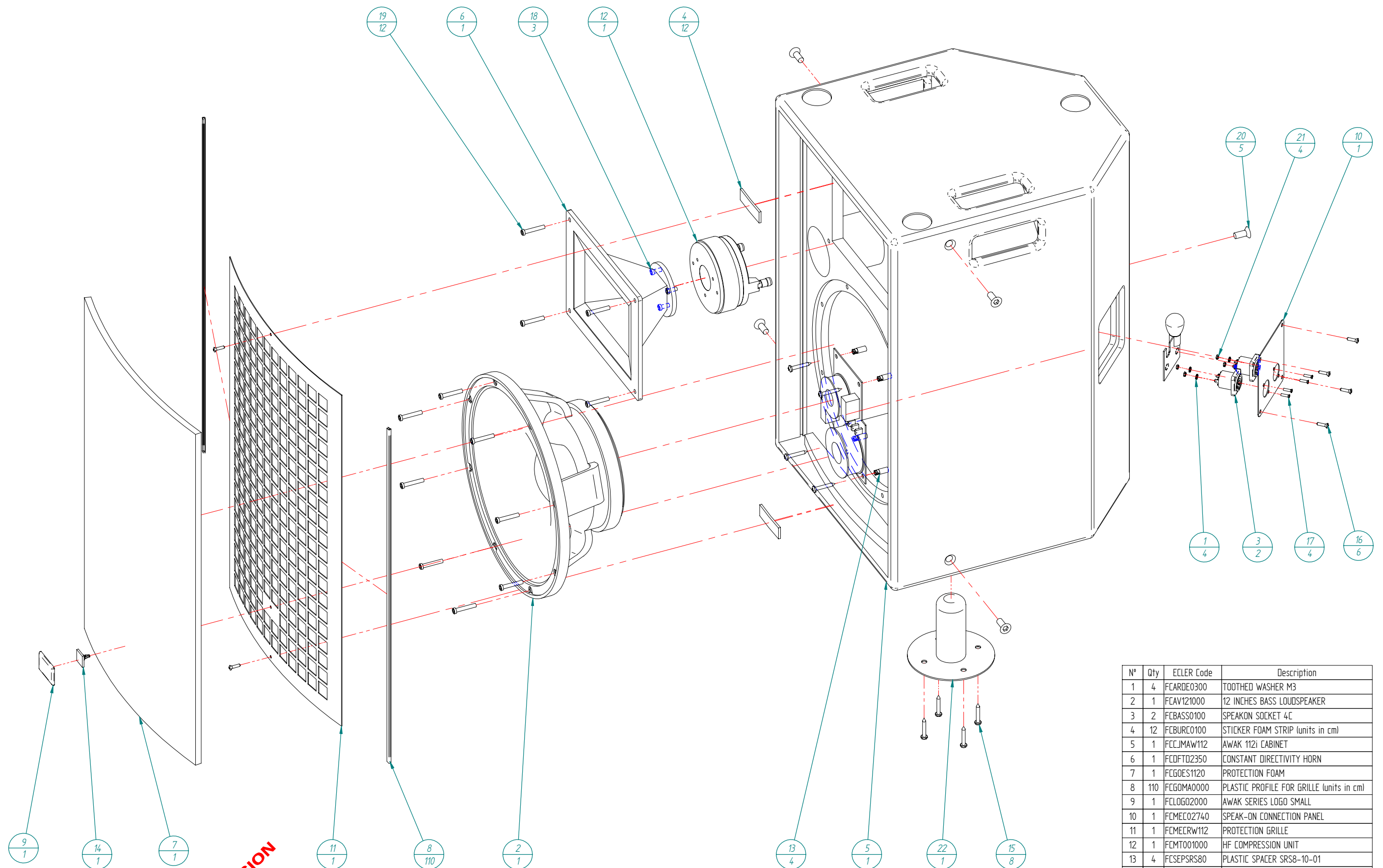

Nº	Qty	ECLER Code	Description
1	4	FCARDE0300	TOOTHED WASHER M3
2	1	FCAV121000	12 INCHES BASS LOUDSPEAKER
3	2	FCBASS0100	SPEAKON SOCKET 4C
4	12	FCBURC0100	STICKER FOAM STRIP (units in cm)
5	1	FCCJMAW112	AWAK 112i CABINET
6	1	FCDFTD2350	CONSTANT DIRECTIVITY HORN
7	1	FCGOES1120	PROTECTION FOAM
8	110	FCGOMA0000	PLASTIC PROFILE FOR GRILLE (units in cm)
9	1	FCLOG02000	AWAK SERIES LOGO SMALL
10	1	FCMEC02740	SPEAK-ON CONNECTION PANEL
11	1	FCMECRW112	PROTECTION GRILLE
12	1	FCMT001000	HF COMPRESSION UNIT
13	4	FCSEPSRS80	PLASTIC SPACER SRS8-10-01
14	1	FCSOPLC100	PLASTIC SUPPORT FOR LOGO
15	8	FCO604530	SCREW D RA81 4,5x30B
16	6	FCO703517	SCREW DIN RA83 3,5x17B
17	4	FCO3503012	SCREW DIN966 M3x12
18	3	FCOALL5120	SCREW DIN912 M5x12 ALLEN
19	12	FCOALL5300	SCREW DIN912 M5x30
20	5	FCOALL8200	SCREW D7991 M8x20 ALLEN
21	4	FCOUE00300	NUT M3
22	1	FCVASTH400	FLANGE FOR LOUDSPEAKER BOX

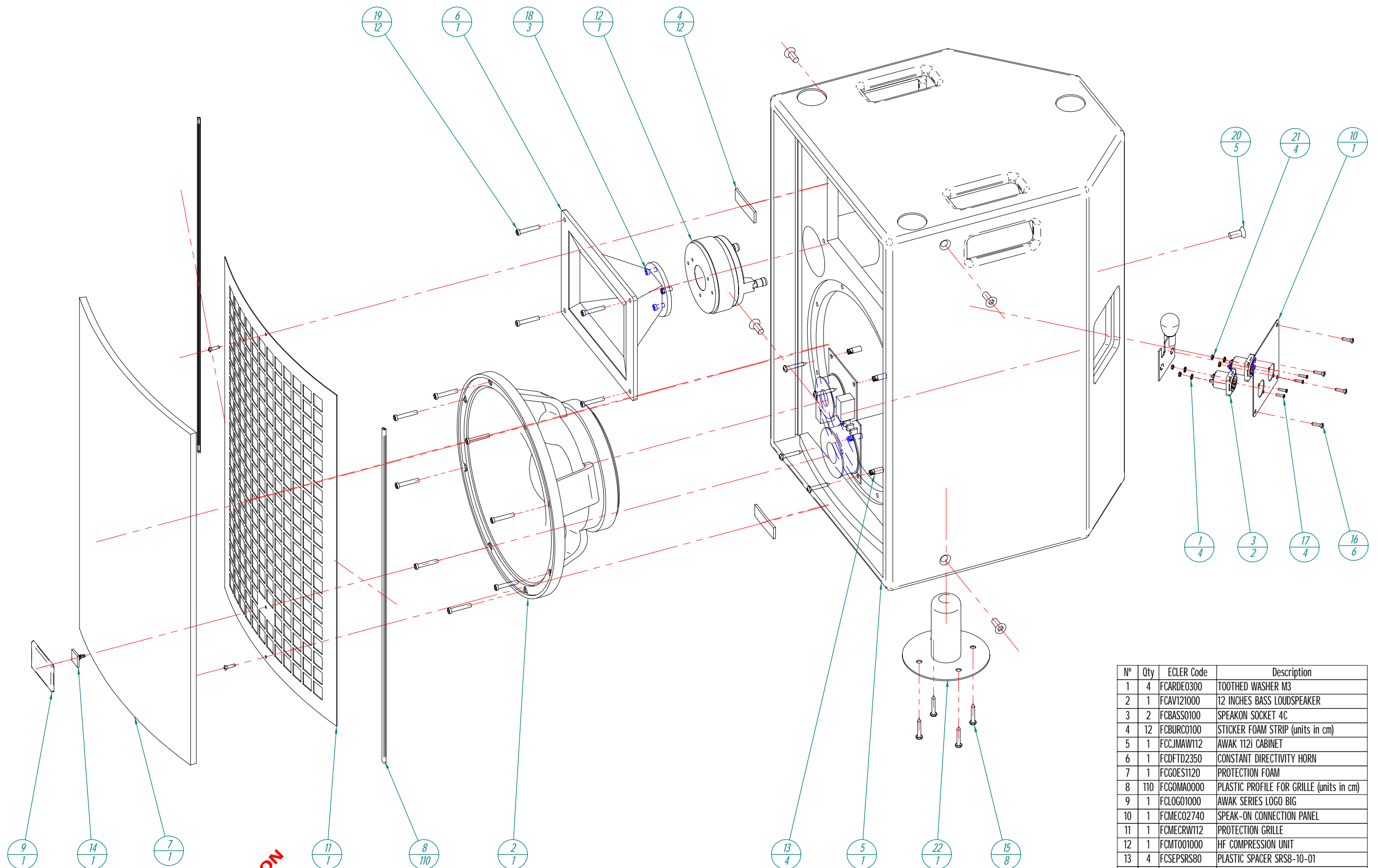

OLD VERSION

Nº	Qty	ECLER Code	Description
1	4	FCARDE0300	TOOTHED WASHER M3
2	1	FCV121000	12 INCHES BASS LOUDSPEAKER
3	2	FCBASS0100	SPEAKON SOCKET 4C
4	12	FCBURC0100	STICKER FOAM STRIP (units in cm)
5	1	FCCJMAW112	AWAK 112i CABINET
6	1	FCDFTD2350	CONSTANT DIRECTIVITY HORN
7	1	FCGOES1120	PROTECTION FOAM
8	110	FCGOMA0000	PLASTIC PROFILE FOR GRILLE (units in cm)
9	1	FCLOGO1000	AWAK SERIES LOGO BIG
10	1	FCMEC02740	SPEAK-ON CONNECTION PANEL
11	1	FCMECRW112	PROTECTION GRILLE
12	1	FCMT001000	HF COMPRESSION UNIT
13	4	FCSEPSRS80	PLASTIC SPACER SRS8-10-01
14	1	FCSOPLC100	PLASTIC SUPPORT FOR LOGO
15	8	FCT0604530	SCREW D RA81 4,5x30B
16	6	FCT0703517	SCREW DIN RA83 3,5x17B
17	4	FCT3503012	SCREW DIN966 M3x12
18	3	FCTALL5120	SCREW DIN912 M5x12 ALLEN
19	12	FCTALL5300	SCREW DIN912 M5X30
20	5	FCTALL8200	SCREW D7991 M8x20 ALLEN
21	4	FCTUE00300	NUT M3
22	1	FCVASTH400	FLANGE FOR LOUDSPEAKER BOX

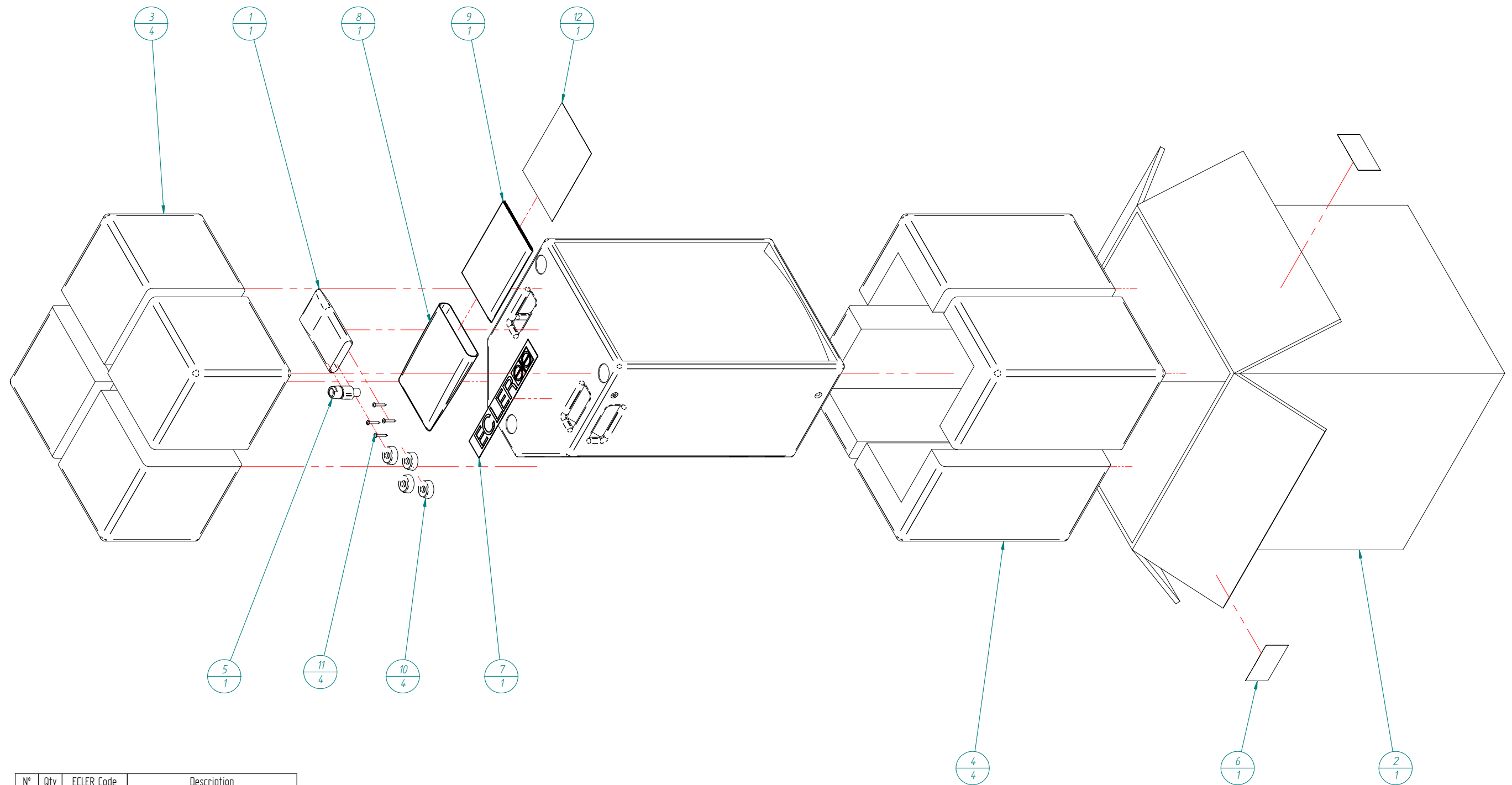

Nº	Qty	ECLER Code	Description
1	1	FCBOL0020000	PLASTIC BAG 120x180
2	1	FCCAJSTA0800	PACKING CARDBOARD BOX
3	4	FCCANT107000	INTERIOR PACKING REINFORCEMENT
4	4	FCCANT111000	INTERIOR PACKING REINFORCEMENT
5	1	FCCONSP10000	MALE SPEAK ON 4C
6	1	FCETI0951140	PRODUCT LABEL PACK (ONE FOR EACH UNIT)
7	1	FCETIECL1000	ECLER STICKER 300x50
8	1	FCFUNMAN0000	USER MANUAL BAG
9	1	FCMANAWAK100	USER MANUAL AWAKi
10	4	FCPIE4906000	RUBBER FOOT 38x15
11	4	FCI060453000	SCREW D RA81 4,5x30B
12	1	FCTARJG00000	WARRANTY CARD

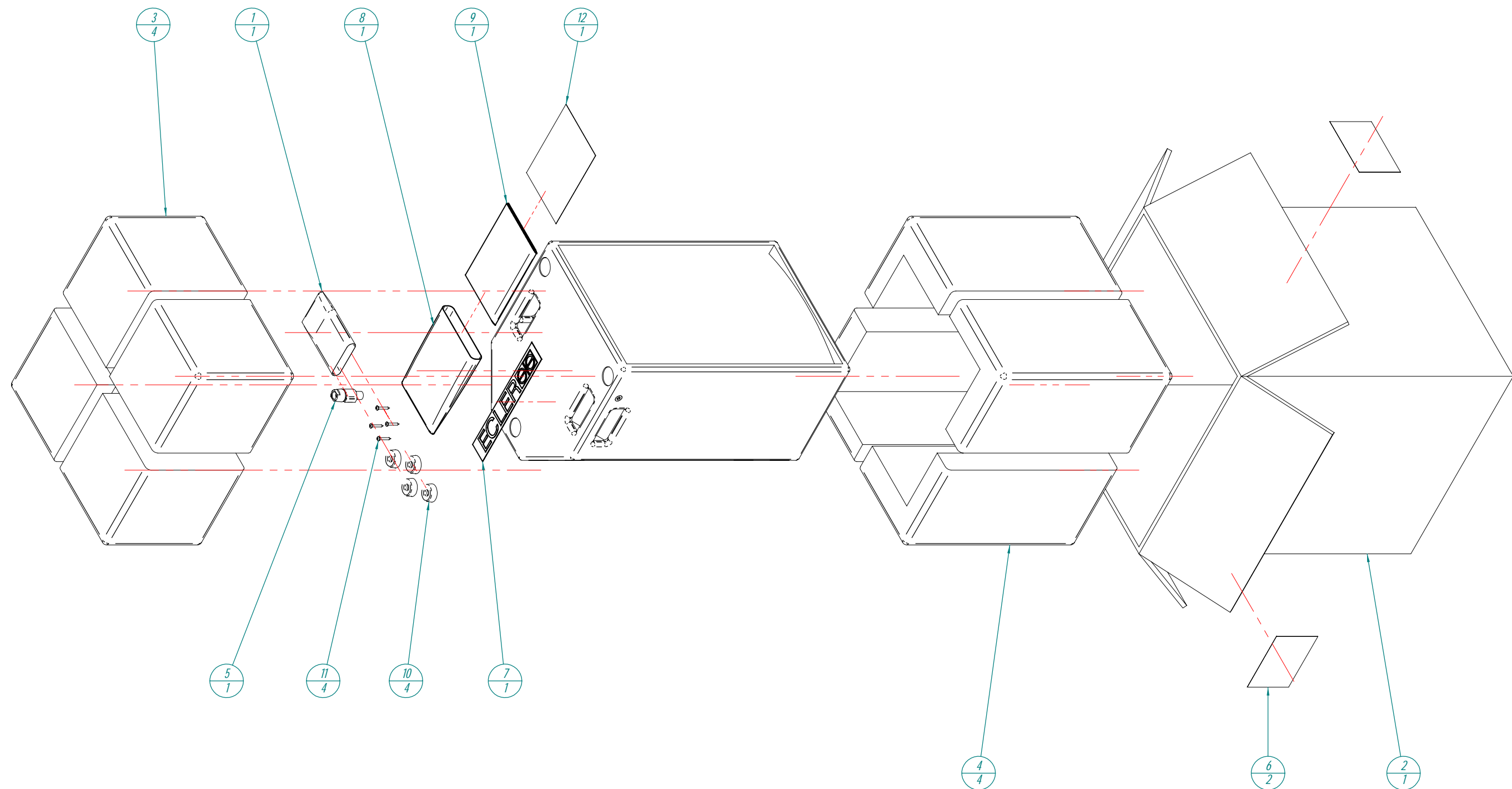

Nº	Qty	ECLER Code	Description
1	1	FCBOL00200	PLASTIC BAG 120x180
2	1	FCCAUSTA08	PACKING CARDBOARD BOX
3	4	FCCANT1070	INTERIOR PACKING REINFORCEMENT
4	4	FCCANT1110	INTERIOR PACKING REINFORCEMENT
5	1	FCCONSP100	MALE SPEAK ON 4C
6	2	FCETICAJA2	PRODUCT INFORMATION LABEL
7	1	FCETIECL10	ECLER STICKER 300x50
8	1	FCFUNMAN00	USER MANUAL BAG
9	1	FCMANAWAK1	USER MANUAL AWAKi
10	4	FCPIE49060	RUBBER FOOT 38x15
11	4	FCTO604530	SCREW D RA81 4,5x30B
12	1	FCTARJG000	WARRANTY CARD

OLD VERSION

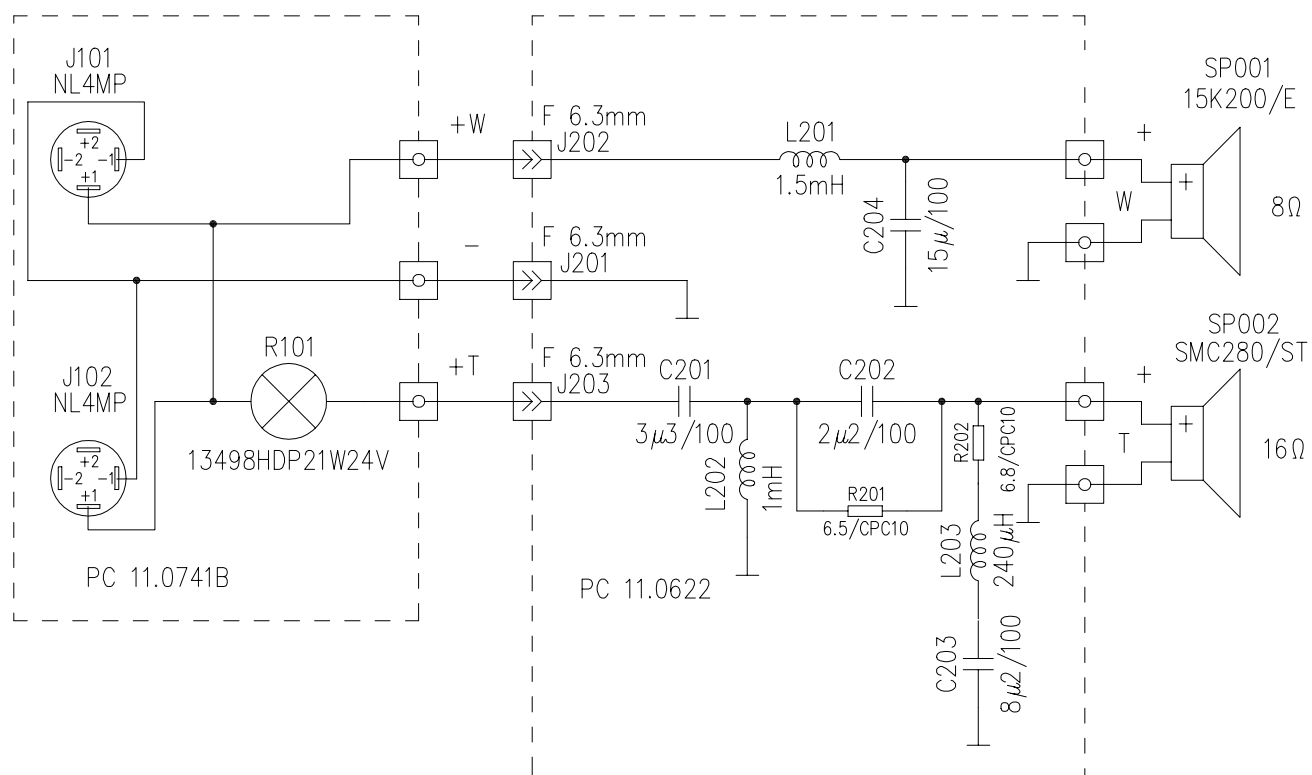

All capacitors 63 V. unless otherwise noted.
Resistors in Ohms. Capacitors in Farads. Inductors in Henries.
All resistors 1/4 W. unless otherwise noted.
See parts list for more information about components.

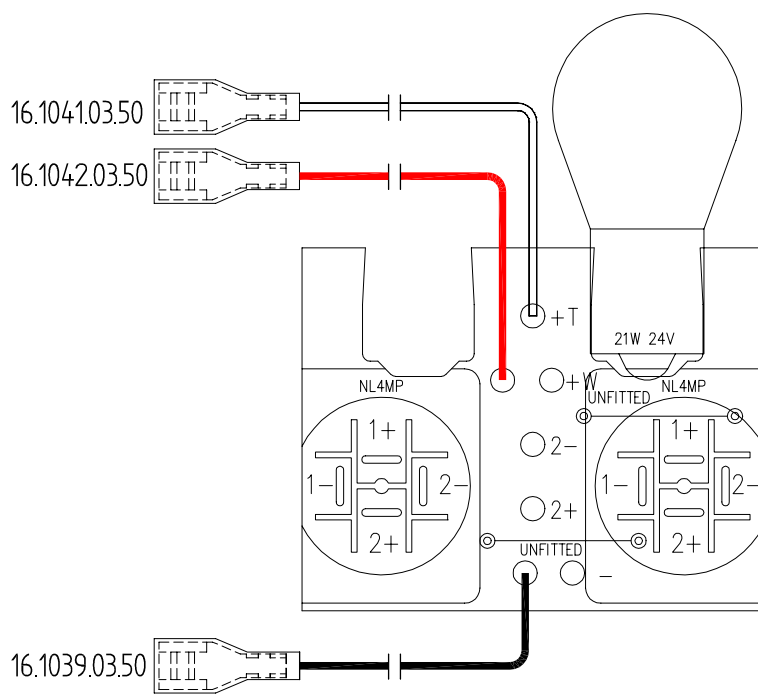

PARTS LIST: PRINTED CIRCUIT 11.0741B

Code	Description	Reference
FCCI074100	Print board 11.0741B	
FCBASS0100	SPEAK-ON NL4MP FASTON	J101
FCBASS0100	SPEAK-ON NL4MP FASTON	J102
FCBM024210	LAMP 24V 21W.	R101
FC0H039350	WIRE 16.1039.03.50	
FC0H041350	WIRE 16.1041.03.50	
FC0H042350	WIRE 16.1042.03.50	

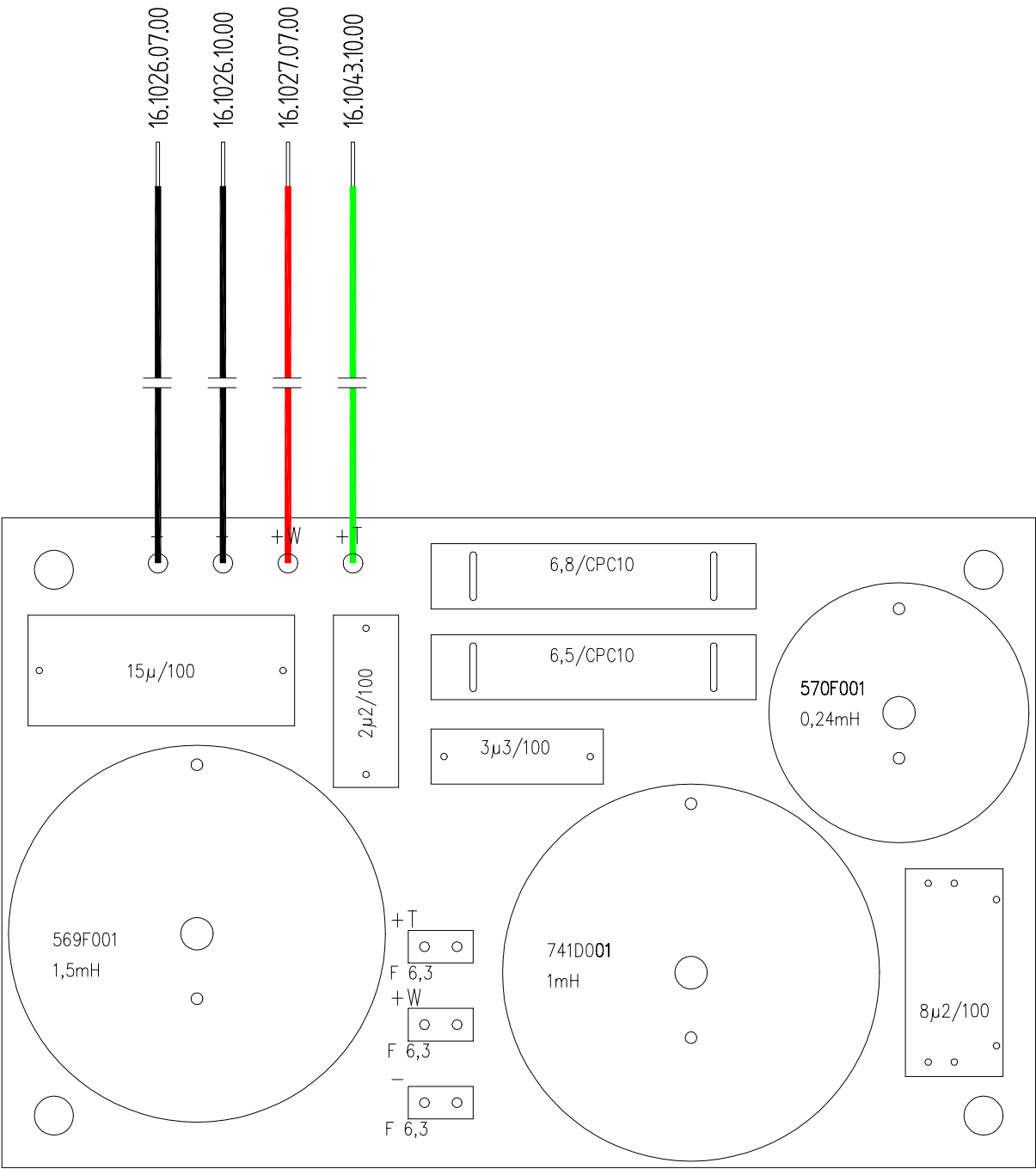

IMPORTANT NOTES:
- Apply Clear Silicone Sealant in all the capacitors.
- The three coils must be riveted.

ECLEREE

drawn: *J. Colomines*
approved:

date: *03/2/17*
title:

project:

C17-02

product:

AWAK115iF

number: *33.0830* version: *01.01*

11.0622 Value

PARTS LIST: PRINTED CIRCUIT 11.0622

Code	Description	Reference
FCCDR10033	CONDEN.CMR 5% 3,3mF100v R-22.5	C201
FCCDR10022	CONDEN.CMR 5% 2.2uF100v R-22.5	C202
FCCDR10015	COND.CMR 5% 1,5uF 100V R-22.5	C203
FCCDR10068	COND.CMR 5% 6.8uF 100V R-27.5	C203
FCCDR10150	CONDEN.CMR 5% 15uF100v R-37.5	C204
FCTERMF630	FASTON 6,3mm	J201
FCTERMF630	FASTON 6,3mm	J202
FCTERMF630	FASTON 6,3mm	J203
FCBB000250	BOBINA 1.5mH 1.2mm 569F001	L201
FCBB000700	BOBINA 1 mH 1 mm 741D001	L202
FCBB000260	BOBINA 240micH 1mm 570F001	L203
FCRYD01550	RESIS.BOB.6.5 ohm CPC10 10w 5%	R201
FCRYD01552	RESIS.BOBI.6.8ohm CPC10 10w 5%	R202
FCCIFLT030	C.I.FR4 35mC 11.0622 FILT.FRA	
FC0H026700	WIRE 16.1026.07.00	
FC0H027700	WIRE 16.1027.07.00	
FC7H026000	WIRE 16.1026.10.00	
FC7H043000	WIRE 16.1043.10.00	

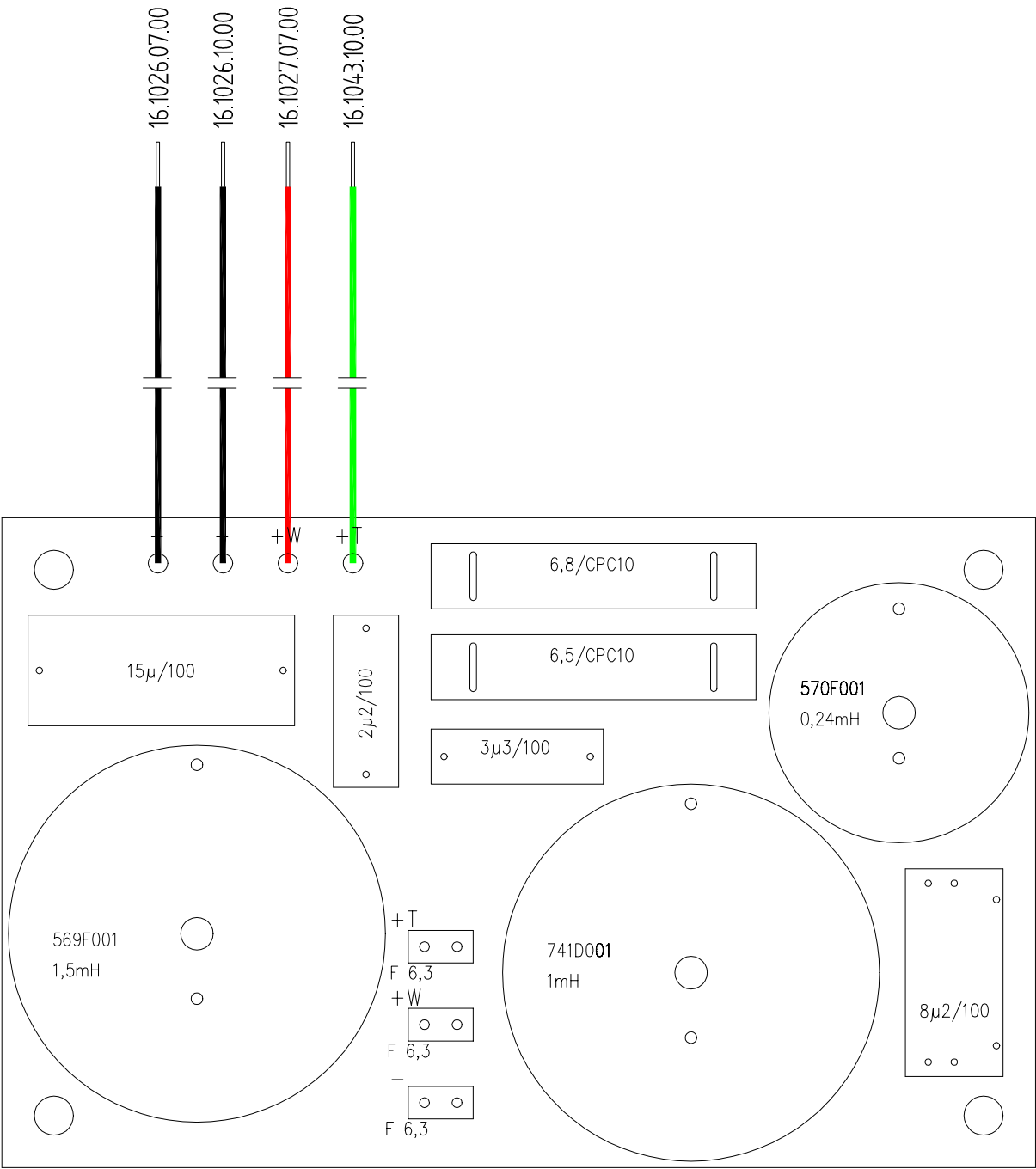

OLD VERSION

ECLEREE

drawn: J. Colomines
approved:

date: 02/03/0
title:

project:

C17-02

product:

AWAK115iF

number: 33.0830 version: 01.00

11.0622 Valors

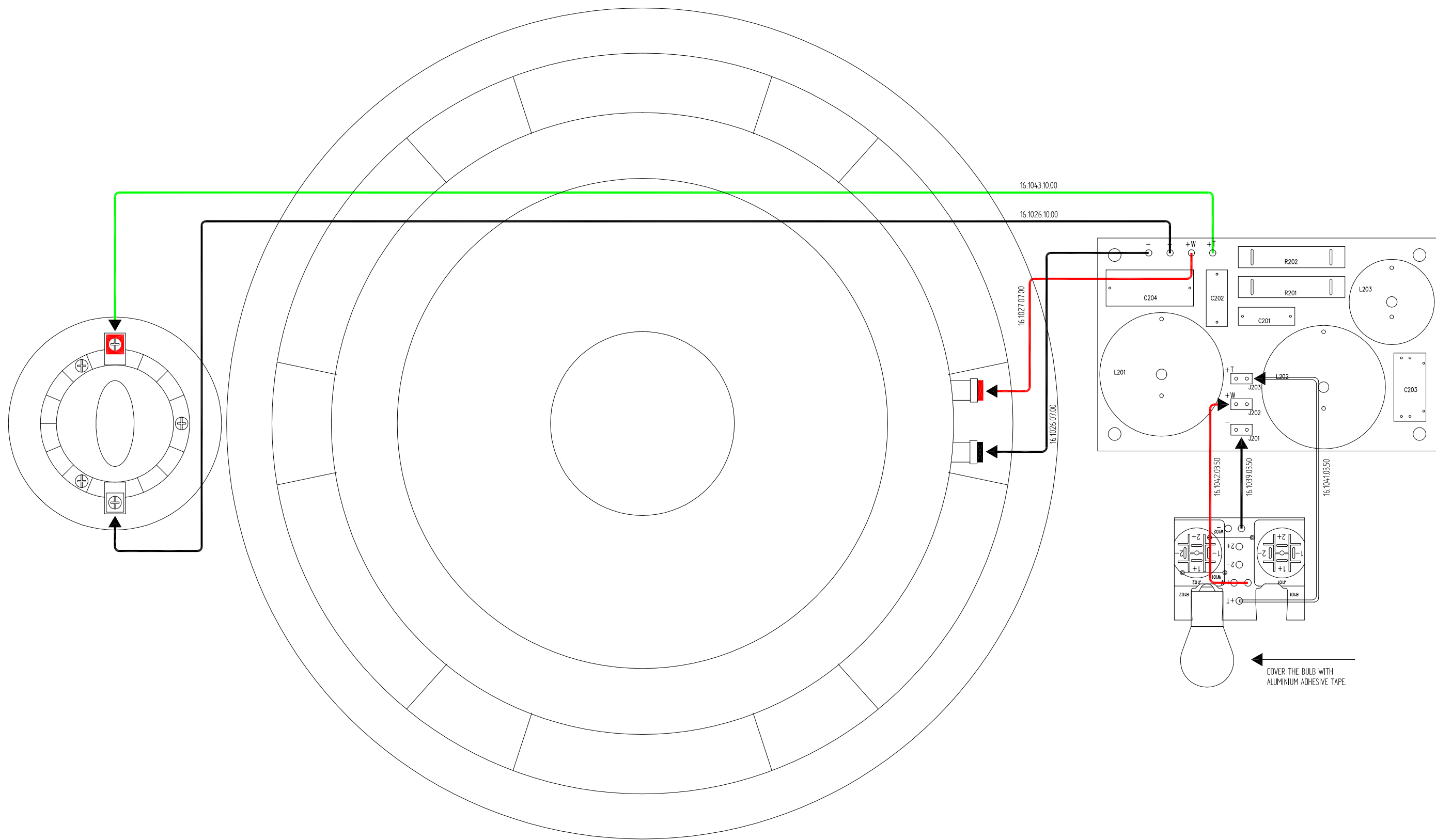

drawn: J. Colomines
approved:

date: 030529
title:

project:

C17-02

product:

AWAK115iF

number: 31.0179
version: 01.01

WIRING DIAGRAM

OLD VERSION

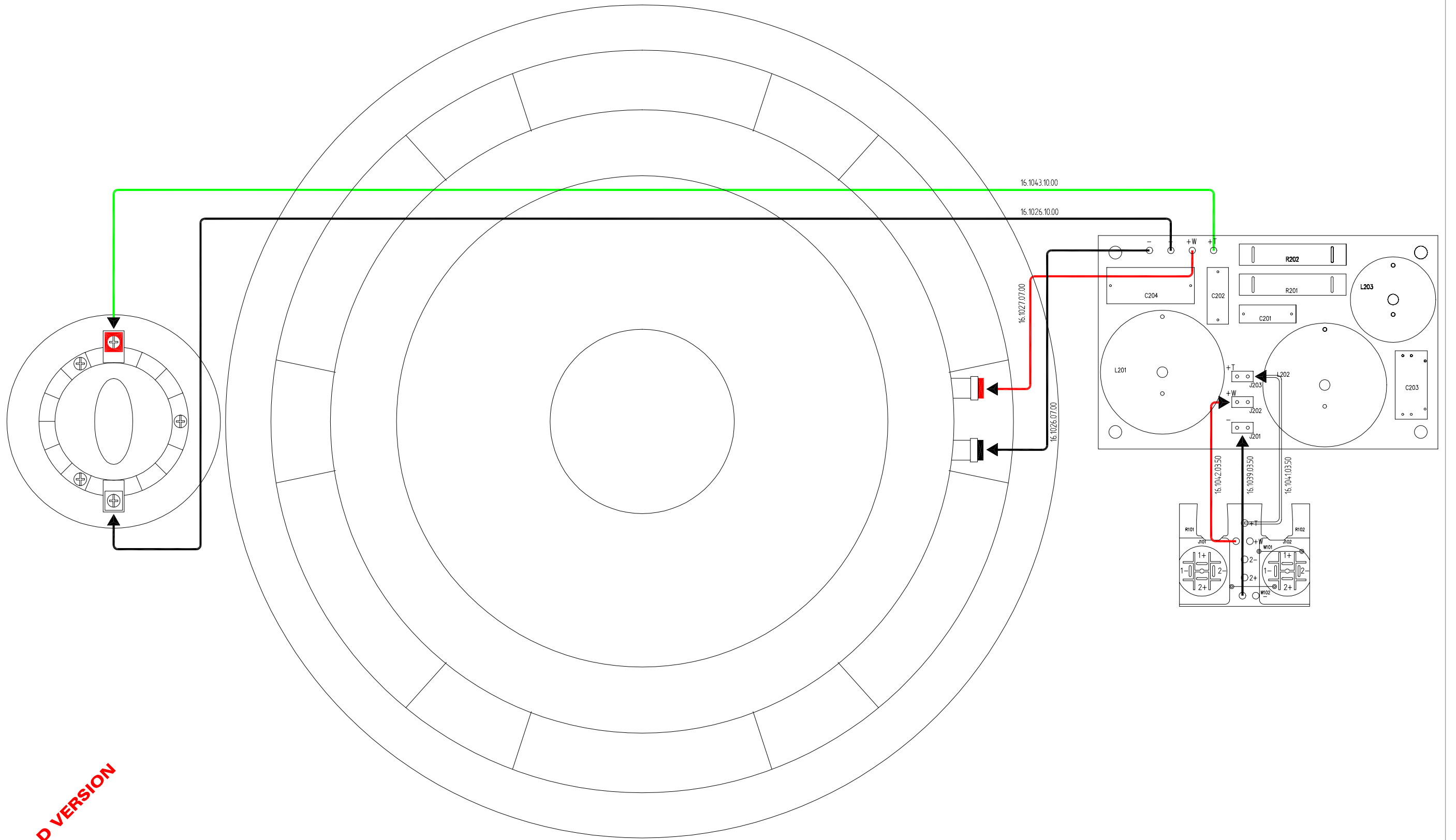

Nº	Qty	ECLER Code	Description
1	4	FCARDE030000	TOOTHED WASHER M3
2	1	FCV15K20000	15 INCHES BASS LOUDSPEAKER
3	2	FCBASS010000	SPEAKON SOCKET 4C
4	12	FCBURE010000	STICKER FOAM STRIP (units in cm)
5	1	FCCJMAW11500	AWAK 115i CABINET
6	1	FCDFD0235000	CONSTANT DIRECTIVITY HORN
7	1	FCGOES115200	PROTECTION FOAM
8	1	FCGOESAWA000	SPEAK-ON PLATE RUBBER SEALANT
9	120	FCGOMA000000	PLASTIC PROFILE FOR GRILLE (units in cm)
10	1	FCLOGO200000	AWAK SERIES LOGO SMALL
11	1	FCMEC0274100	PROTECTION GRILLE
12	1	FCMT00100000	HF COMPRESSION UNIT
13	4	FCSEPSRS8000	PLASTIC SPACER SRS8-10-01
14	1	FCSOPLC10000	PLASTIC SUPPORT FOR LOGO
15	4	FCT060453000	SCREW D RA81 4,5x30B
16	6	FCT070351700	SCREW DIN RA83 3,5x17B
17	4	FCT350301200	SCREW DIN966 M3x12
18	3	FCTALL512000	SCREW DIN912 M5x12 ALLEN
19	12	FCTALL530000	SCREW DIN912 M5x30
20	4	FCTALL635000	SCREW DIN7991 M6x35 ALLEN
21	5	FCTALL820000	SCREW D7991 M8x20 ALLEN
22	4	FCTUE0030000	NUT M3
23	1	FCVASELD00000	FLANGE FOR LOUDSPEAKER BOX
24	1	FPO274000000	SPEAK-ON CONNECTION PANEL

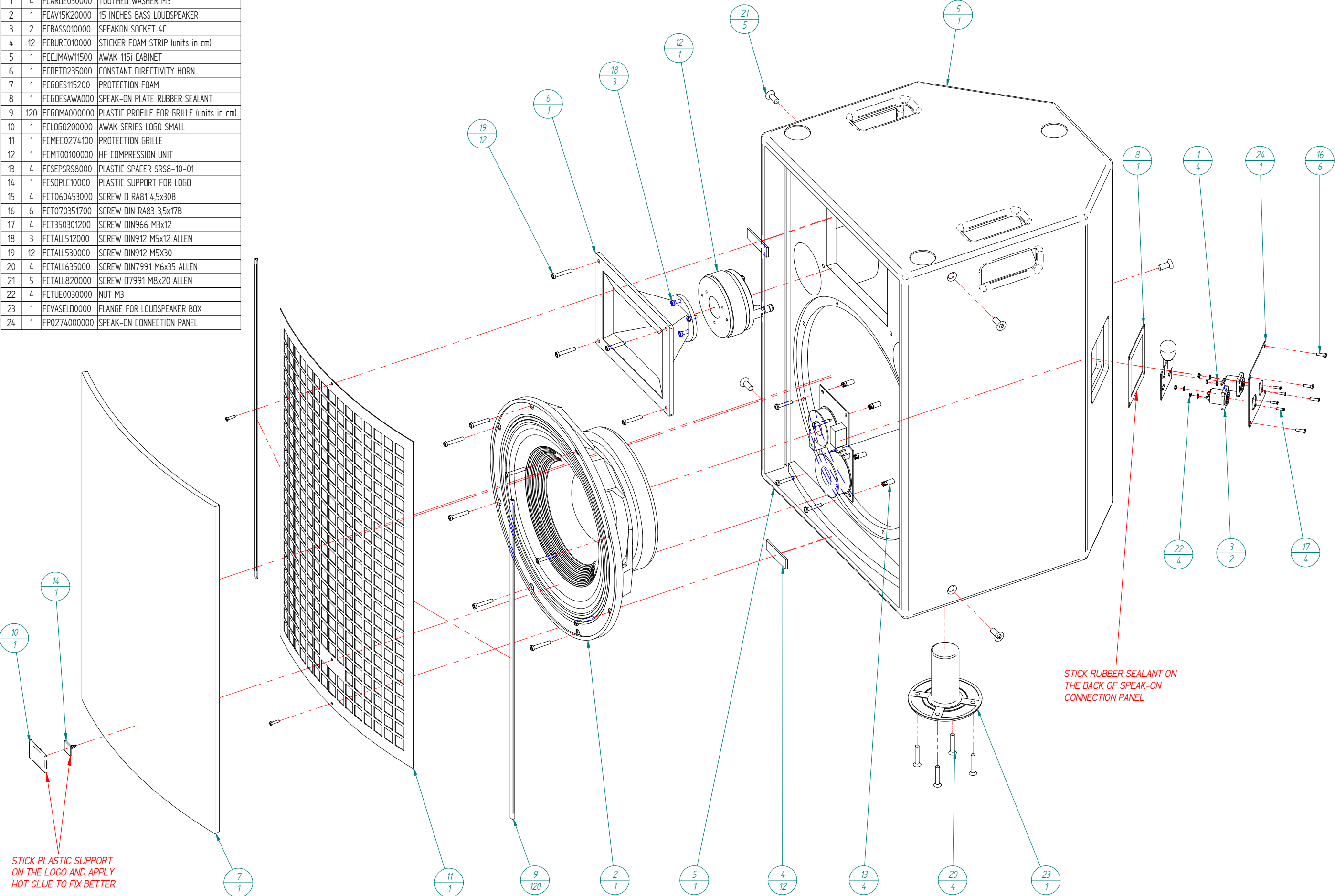

Nº	Qty	ECLER Code	Description
1	4	FCARDE0300	TOOTHED WASHER M3
2	1	FCV15K200	15 INCHES BASS LOUDSPEAKER
3	2	FCBASS0100	SPEAKON SOCKET 4C
4	12	FCBURC0100	STICKER FOAM STRIP (units in cm)
5	1	FCCJMAW115	AWAK 115i CABINET
6	1	FCDFTD2350	CONSTANT DIRECTIVITY HORN
7	1	FCGOES1152	PROTECTION FOAM
8	1	FCGOESAWA000	SPEAK-ON PLATE RUBBER SEALANT
9	120	FCGOMA0000	PLASTIC PROFILE FOR GRILLE (units in cm)
10	1	FCLOGO2000	AWAK SERIES LOGO SMALL
11	1	FCMEC02740	SPEAK-ON CONNECTION PANEL
12	1	FCMEC02741	PROTECTION GRILLE
13	1	FCMT001000	HF COMPRESSION UNIT
14	4	FCSEPSRS80	PLASTIC SPACER SRS8-10-01
15	1	FCSOPLC100	PLASTIC SUPPORT FOR LOGO
16	8	FCT0604530	SCREW D RA81 4,5x30B
17	6	FCT0703517	SCREW DIN RA83 3,5x17B
18	4	FCT3503012	SCREW DIN966 M3x12
19	3	FCTALL5120	SCREW DIN912 M5x12 ALLEN
20	12	FCTALL5300	SCREW DIN912 M5x30
21	5	FCTALL8200	SCREW D7991 M8x20 ALLEN
22	4	FCTUE00300	NUT M3
23	1	FCVASTH400	FLANGE FOR LOUDSPEAKER BOX

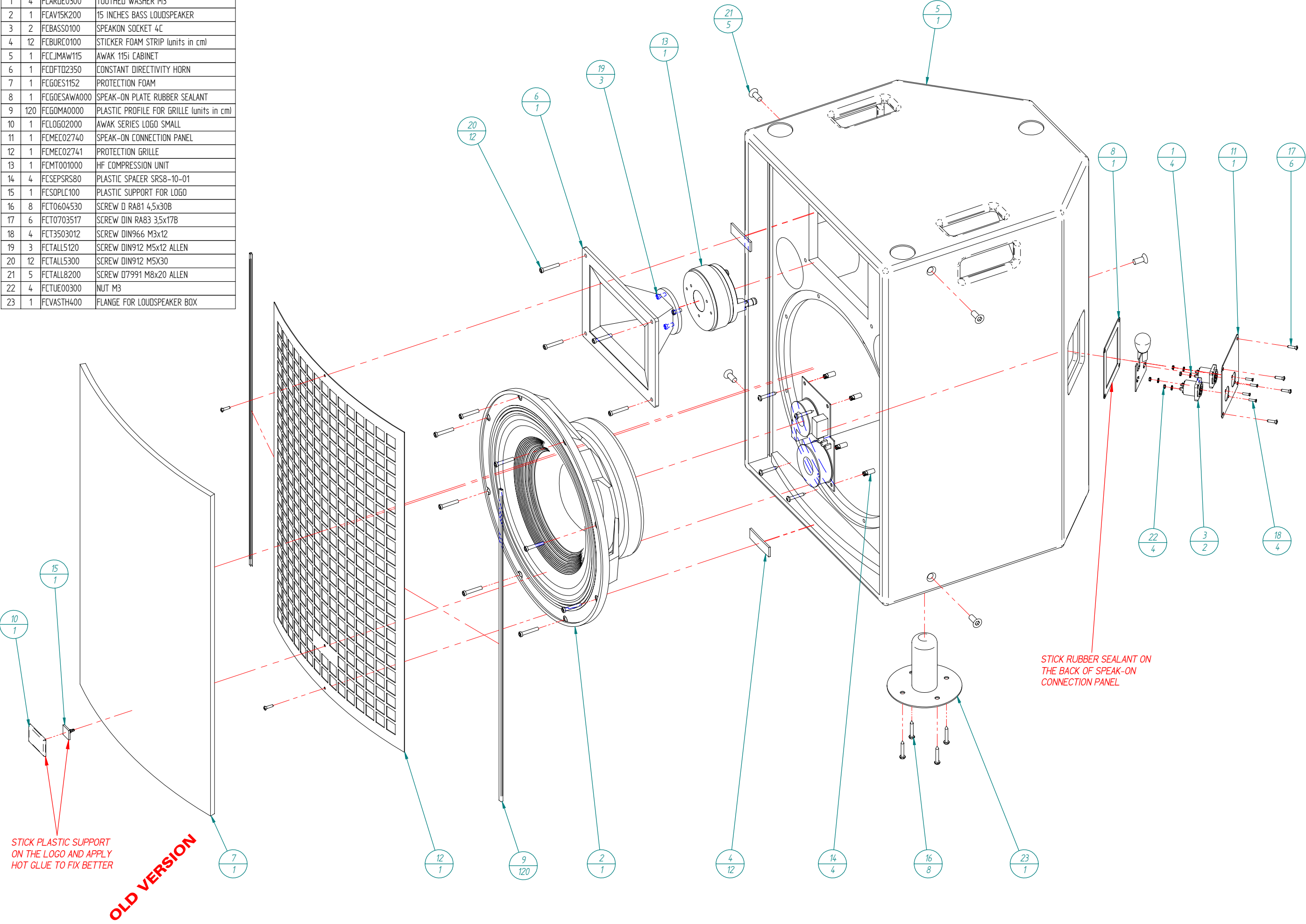

Nº	Qty	ECLER Code	Description
1	4	FCARDE0300	TOOTHED WASHER M3
2	1	FCV15K200	15 INCHES BASS LOUSPEAKER
3	2	FCBASS0100	SPEAKON SOCKET 4C
4	12	FCBURE0100	STICKER FOAM STRIP (units in cm)
5	1	FCCJMAW115	AWAK 115i CABINET
6	1	FCDFD02350	CONSTANT DIRECTIVITY HORN
7	1	FCGOES1152	PROTECTION FOAM
8	120	FCGOMA0000	PLASTIC PROFILE FOR GRILLE (units in cm)
9	1	FCLOG02000	AWAK SERIES LOGO SMALL
10	1	FCMEC02740	SPEAK-ON CONNECTION PANEL
11	1	FCMEC02741	PROTECTION GRILLE
12	1	FCMT001000	HF COMPRESSION UNIT
13	4	FCSEPSRS80	PLASTIC SPACER SRS8-10-01
14	1	FCSOPLC100	PLASTIC SUPPORT FOR LOGO
15	8	FCT0604530	SCREW D RA81 4,5x30B
16	6	FCT0703517	SCREW DIN RA83 3,5x17B
17	4	FCT3503012	SCREW DIN966 M3x12
18	3	FCTALL5120	SCREW DIN912 M5x12 ALLEN
19	12	FCTALL5300	SCREW DIN912 M5x30
20	5	FCTALL8200	SCREW D7991 M8x20 ALLEN
21	4	FCTUE00300	NUT M3
22	1	FCVASTH400	FLANGE FOR LOUSPEAKER BOX

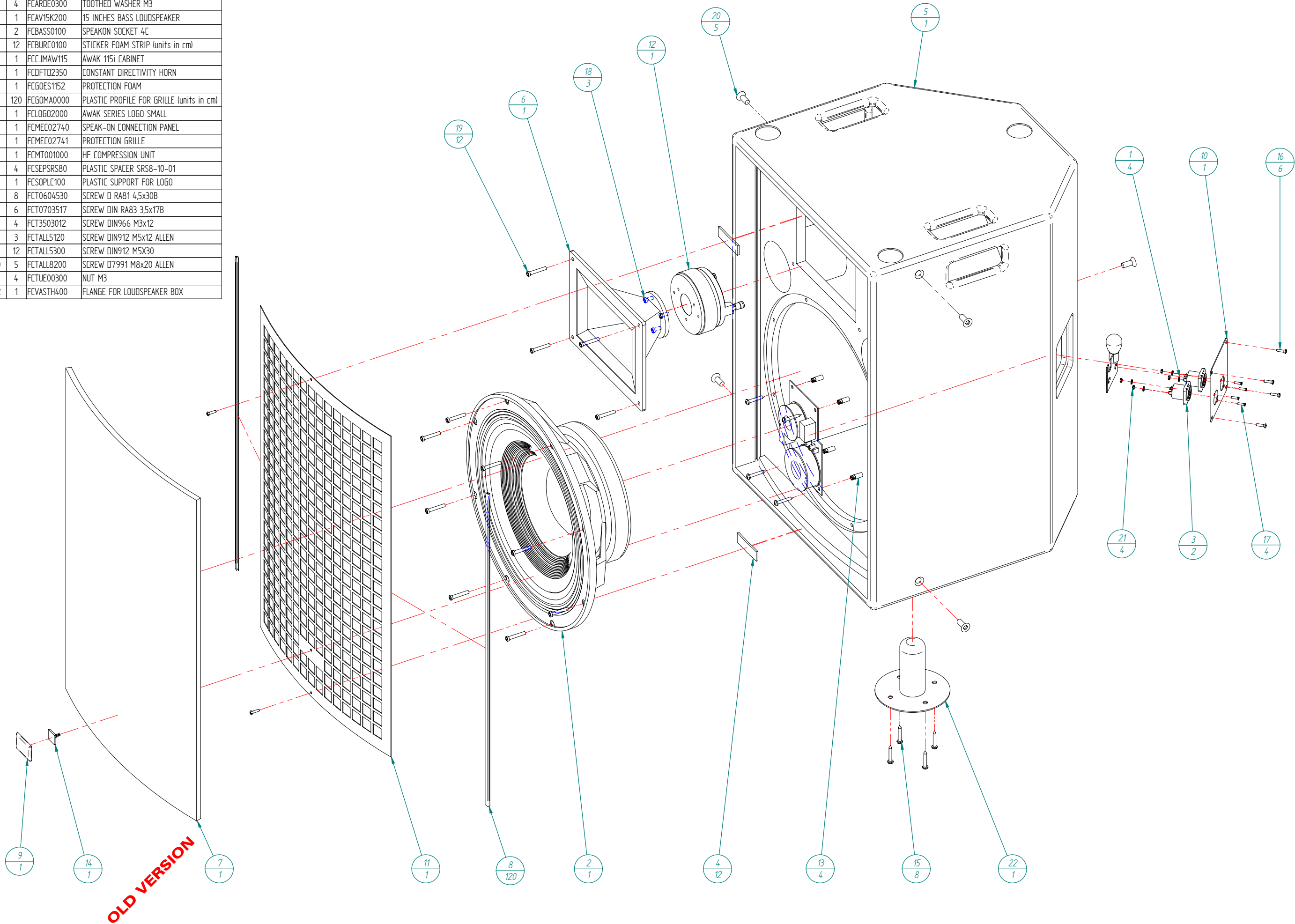

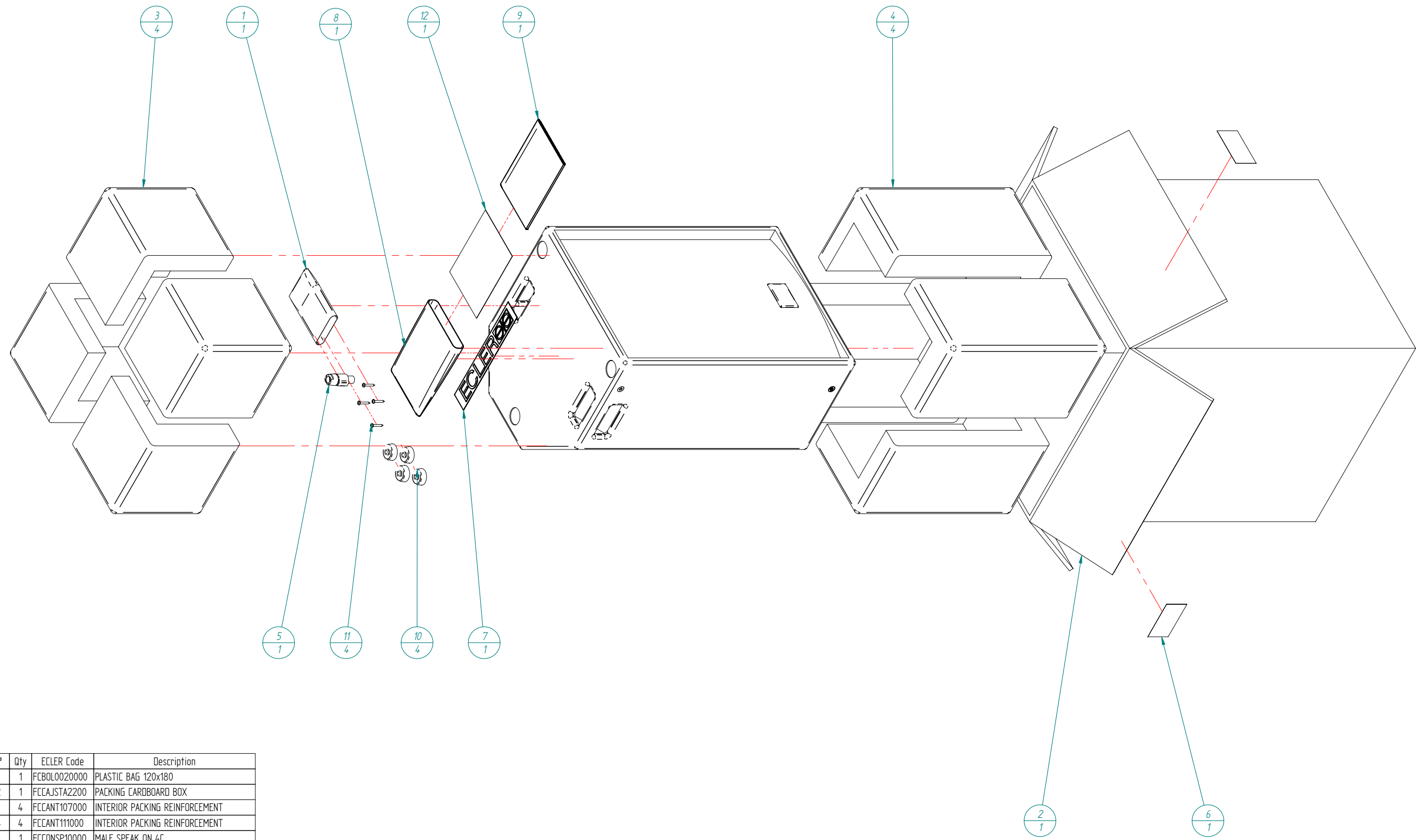

Nº	Qty	ECLER Code	Description
1	1	FCBOL0020000	PLASTIC BAG 120x180
2	1	FCCAJSTA2200	PACKING CARDBOARD BOX
3	4	FCCANT107000	INTERIOR PACKING REINFORCEMENT
4	4	FCCANT111000	INTERIOR PACKING REINFORCEMENT
5	1	FCCONSP10000	MALE SPEAK ON 4C
6	1	FCETI0951140	PRODUCT LABEL PACK (ONE FOR EACH UNIT)
7	1	FCETIECL1000	ECLER STICKER 300x50
8	1	FCFUNMAN0000	USER MANUAL BAG
9	1	FCMANAWAK100	USER MANUAL AWAKi
10	4	FCPIE4906000	RUBBER FOOT 38x15
11	4	FCO60453000	SCREW D RA81 4,5x30B
12	1	FCTARJG00000	WARRANTY CARD

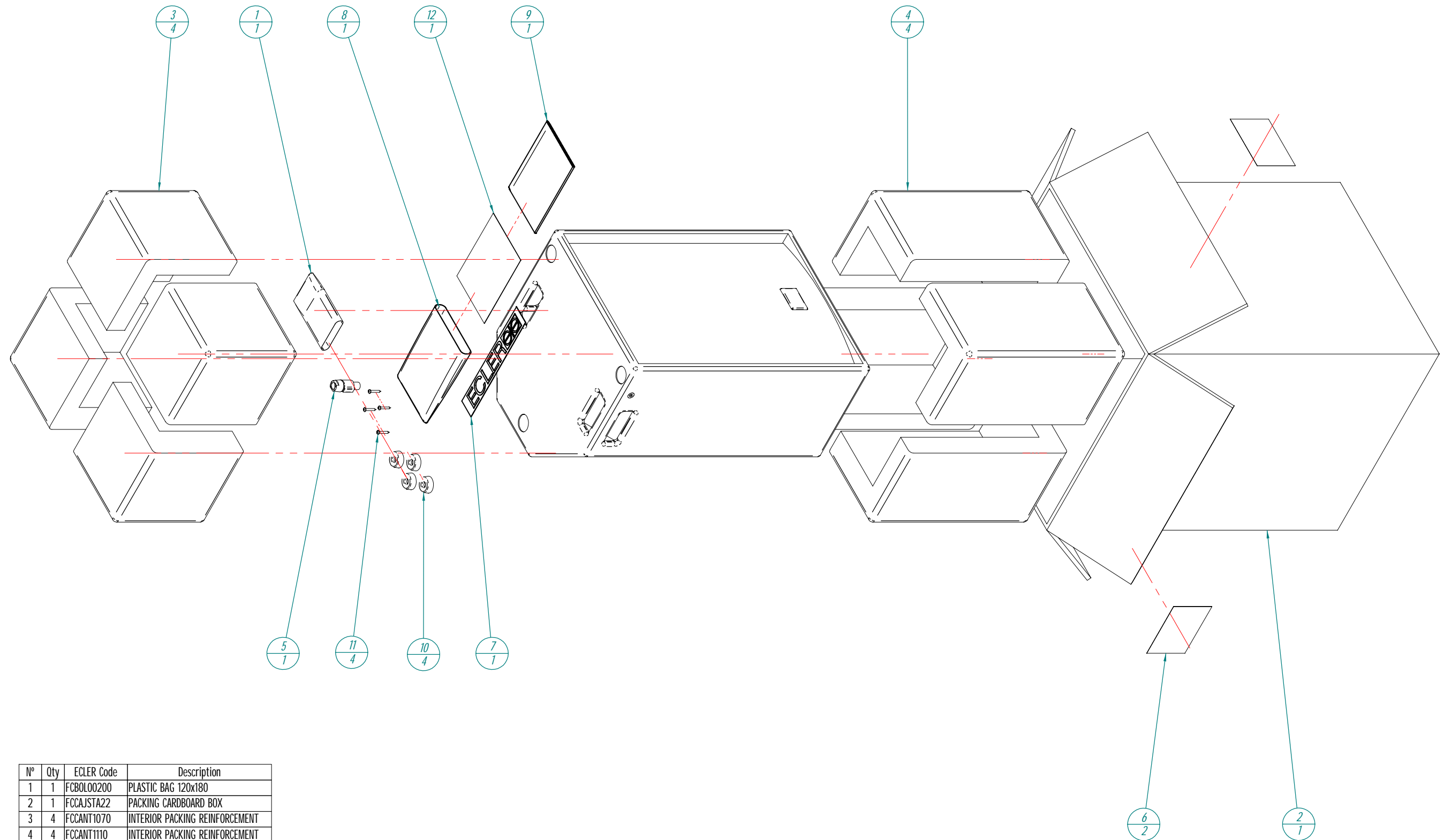

Nº	Qty	ECLER Code	Description
1	1	FCBOL00200	PLASTIC BAG 120x180
2	1	FCCAJSTA22	PACKING CARDBOARD BOX
3	4	FCCANT1070	INTERIOR PACKING REINFORCEMENT
4	4	FCCANT1110	INTERIOR PACKING REINFORCEMENT
5	1	FCCONSP100	MALE SPEAK ON 4C
6	2	FCETICAJA2	PRODUCT INFORMATION LABEL
7	1	FCETIECL10	ECLER STICKER 300x50
8	1	FCFUNMAN00	USER MANUAL BAG
9	1	FCMANAWAK1	USER MANUAL AWAKi
10	4	FCPIE49060	RUBBER FOOT 38x15
11	4	FCTO604530	SCREW D RA81 4,5x30B
12	1	FCTARJG000	WARRANTY CARD

OLD VERSION