



# L2000SD

SWITCHING DIVERSITY  
VHF WIRELESS SYSTEM

# L2000TD

TRUE DIVERSITY  
VHF WIRELESS SYSTEM

preliminary

## SERVICE MANUAL

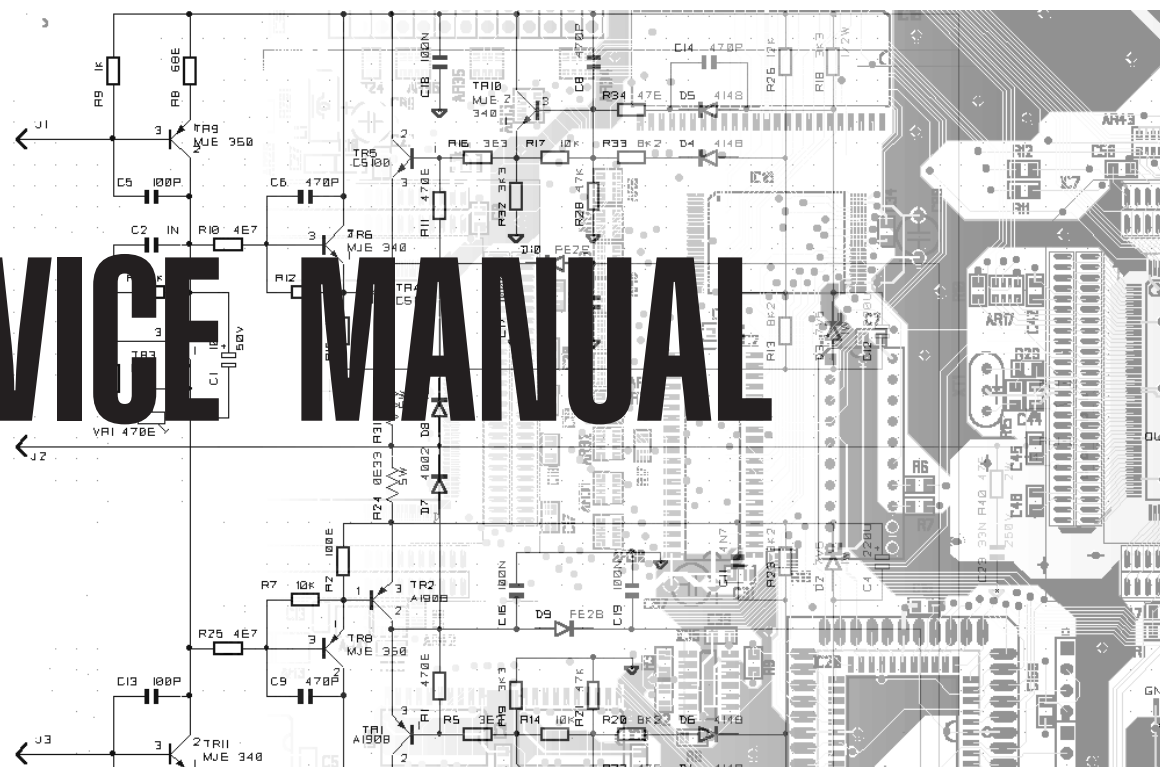

## Index

- 2 L2000-BTX (Body Pack) Assembly, Block Diagram, Adjustments, Spare Part List.
- 3 L2000-BTX (Body Pack) Schematic Diagram 1st Version
- 4 L2000-BTX (Body Pack) Schematic Diagram 2nd Version
- 5 L2000-HTX (Handheld) Schematic Diagram 1st Version
- 6 L2000-SD (Switching Diversity Receiver) Assembly, Block Diagram, Adjustments, Spare Part List.
- 7 L2000-SD (Switching Diversity Receiver) Schematic Diagram
- 8 L2000-TD (True Diversity Receiver) Assembly, Block Diagram, Adjustments.
- 9 L2000-TD (True Diversity Receiver) Schematic Diagram

## Warnings



### Notice

Service must be carried out by qualified personnel only. Any tampering carried out by unqualified personnel during the guarantee period will forfeit the right to guarantee.

For a correct operation of the instrument, after having switched off, be careful to wait at least 3 seconds before switching on again.

To improve the device's specifications, the schematic diagrams may be subject to change without prior notice.

All components marked by this symbol have special safety characteristics, when replacing any of these components use only manufacturer's specified parts.

The ( $\mu$ ) micro symbol of capacitance value is substituted by U.

The ( $\Omega$ ) omega symbol of resistance value is substituted by E.

The electrolytic capacitors are 25Vdc rated voltage unless otherwise specified.

All resistors are 1/8W unless otherwise specified.

All switches shown in the "OFF" position. All DC voltages measured to ground with a voltmeter 20KOhm/V.

← Soldering point.

• Male connector.

○ Female connector.

— M/F faston connector.

↑ Supply voltage.

□ Test point.

◊ Flag joined with one or more flags

with the same signal name inscribed.

⊥ Logic supply ground.

⊥ Analog supply ground.

⊥ Chassis ground.

⊥ Earth ground.



### ATTENTION

Observe precautions when handling electrostatic sensitive devices.

## Address



GENERALMUSIC S.p.A. Sales Division: 47842 S.Giovanni in Marignano (RN) ITALY - Via delle Rose, 12



Phone +39(0)541/959511 - Fax +39(0)541/957404 - GENERALMUSIC on the NET: <http://www.generalmusic.com>



CODE: 270262

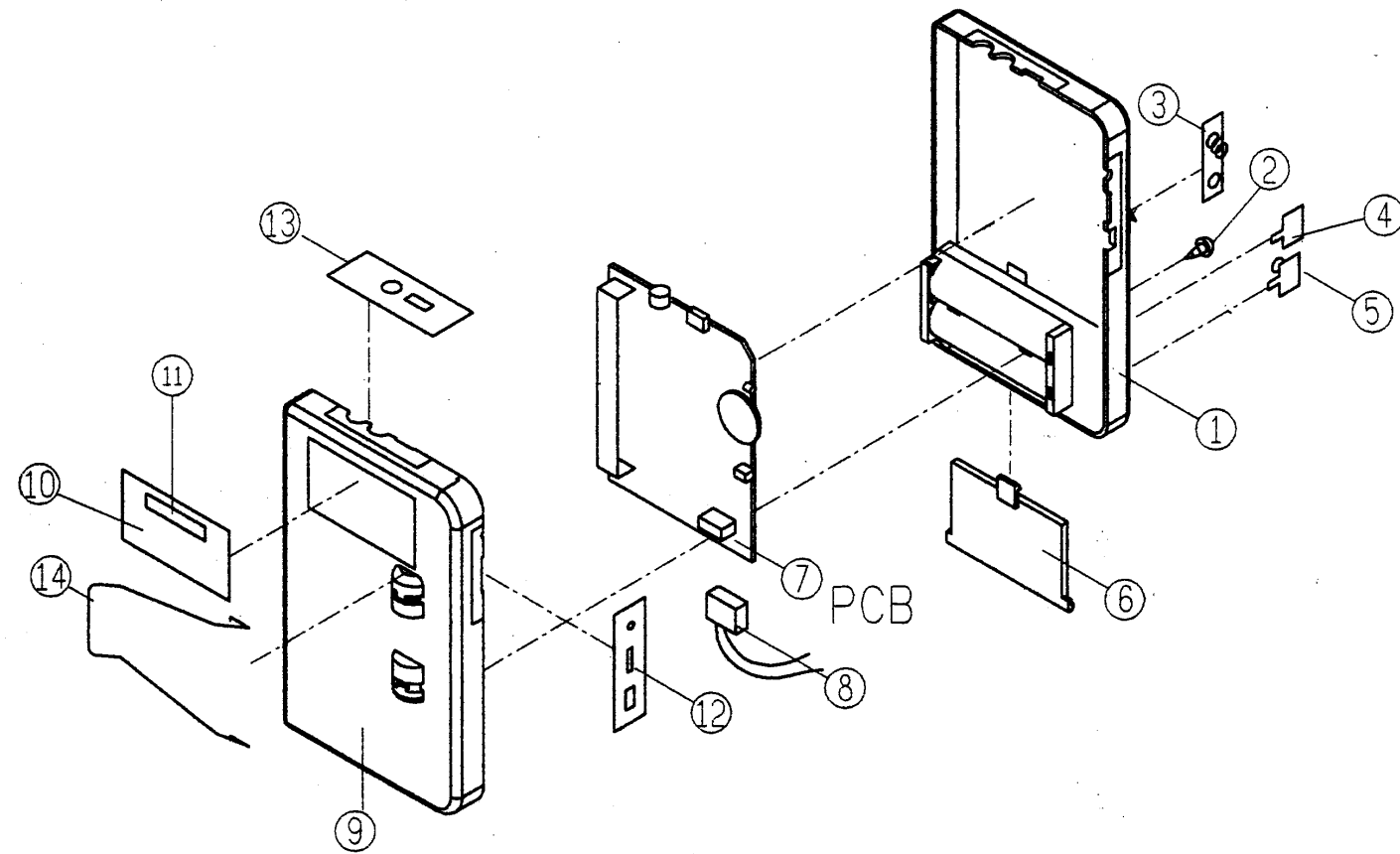

(NOT AVAILABLE)

### L2000-BTX Block Diagram

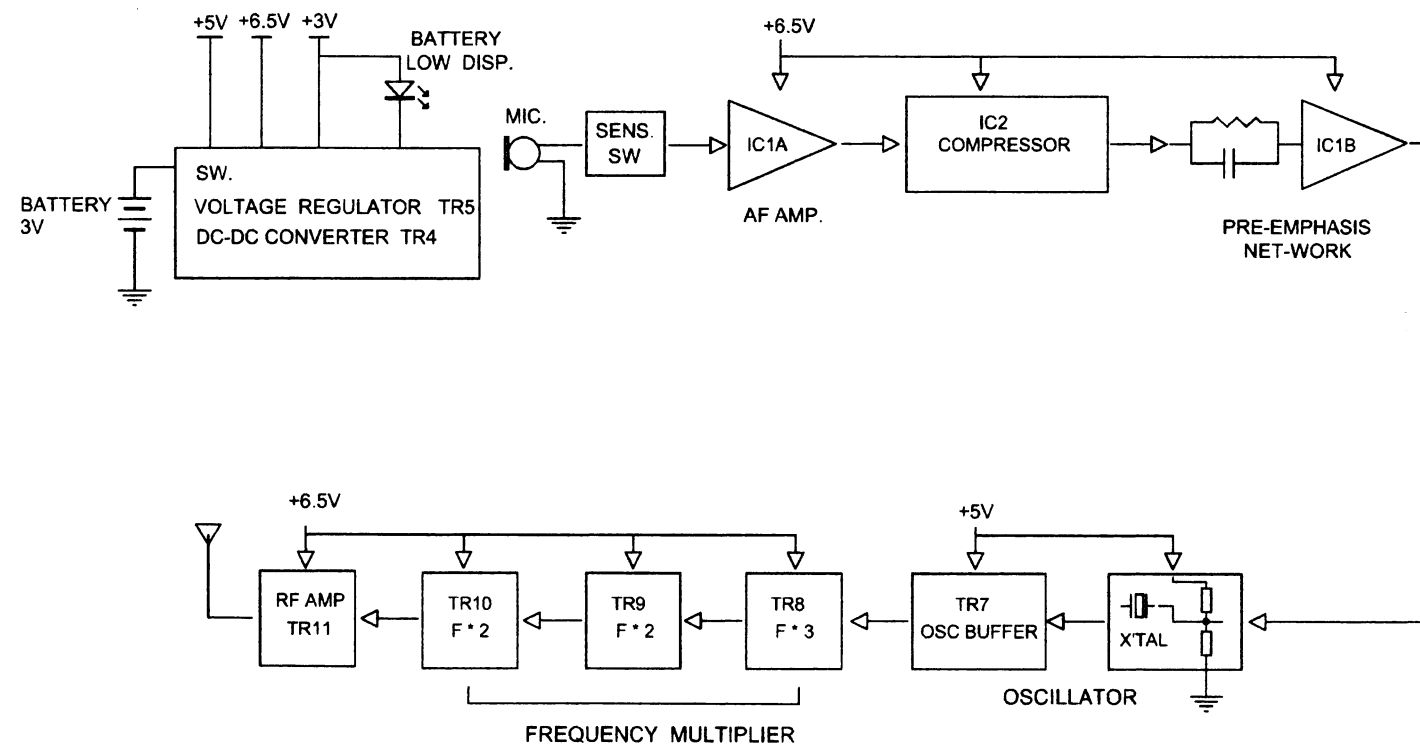

## L2000-BTX Spare Part List

### PARTS AVAILABLE UP TO TODAY (DECEMBER 2001)

110289	9V Alkaline Battery Type 6LR61
SKK888002	L2000-BTX BODYPACK TRANSMITTER
SKK888003	LT-1 LAVALIER MICROPHONE
SKK888028	* LAVALIER PEG SUPPORT FOR LT-1
SKK888024	* FOAM WINDSCREEN FOR LT-1
SKK888004	ST-1 HEADSET MICROPHONE
SKK888026	* HEADSET SUPPORT FOR ST-1
SKK888025	* FOAM WINDSCREEN FOR ST-1
SKK888005	GT-1 INSTRUMENT CABLE
SKK888001	L2000-HTX HANDHELD MICROPHONE
SKK888027	* DYNAMIC CARDIOID MICROPHONE CAPSULE

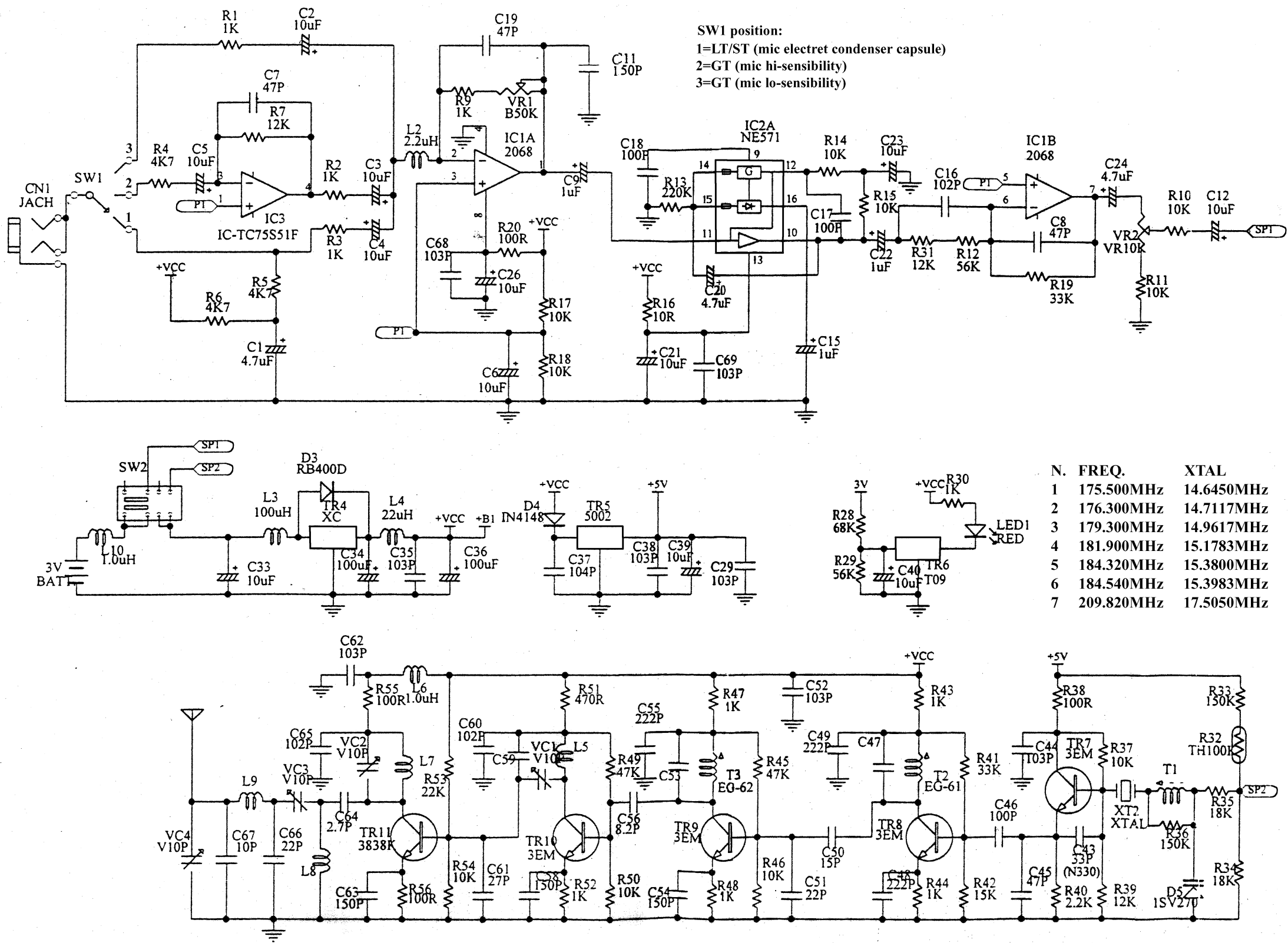

SW1 positions:

- 1 - ST/LT (mic electret condenser capsule)
- 2 - GT (mic hi-sensibility)
- 3 - GT (mic lo-sensibility)

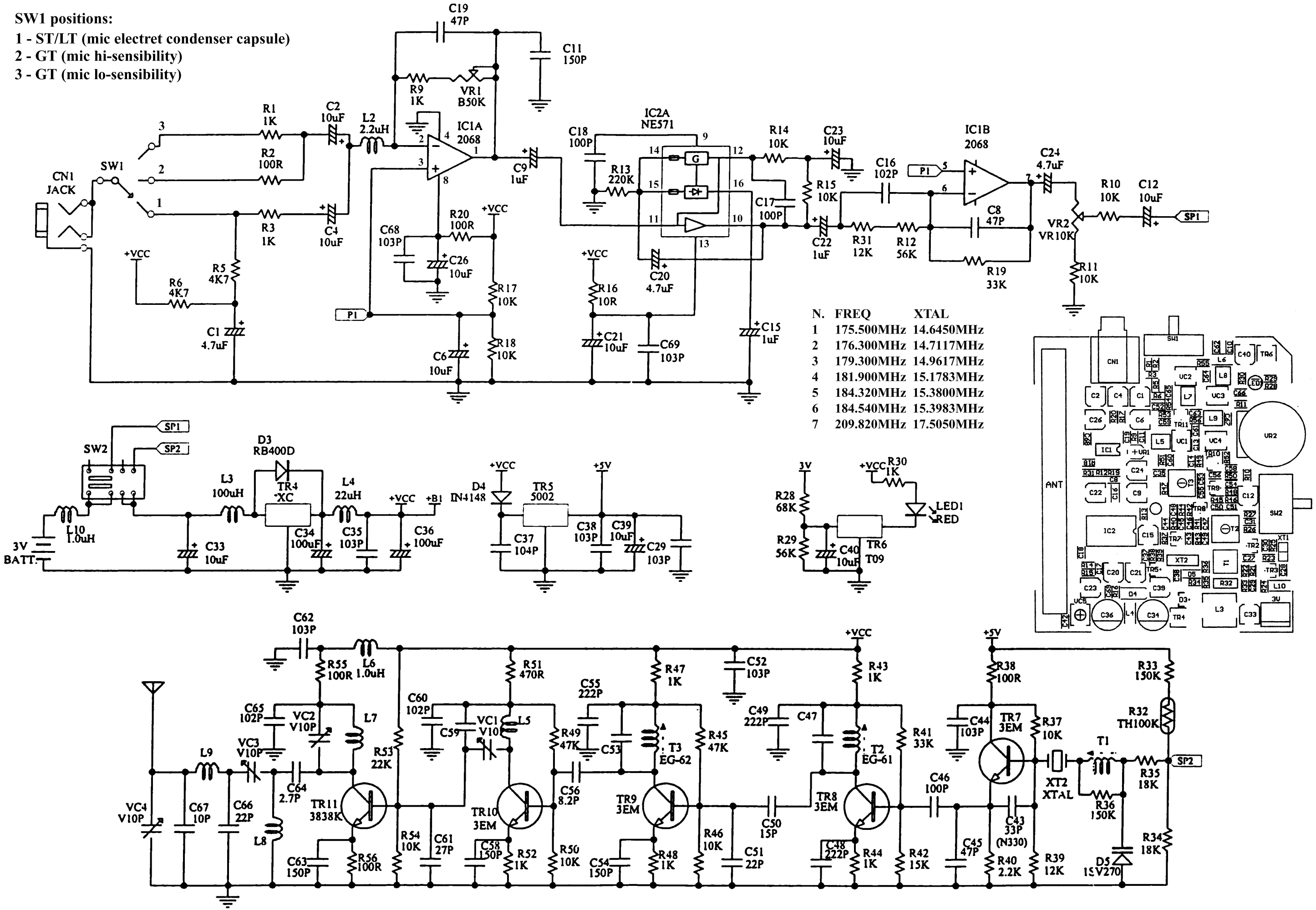

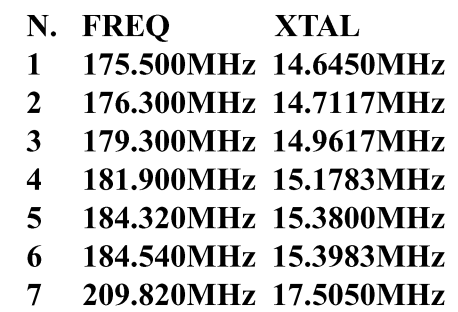

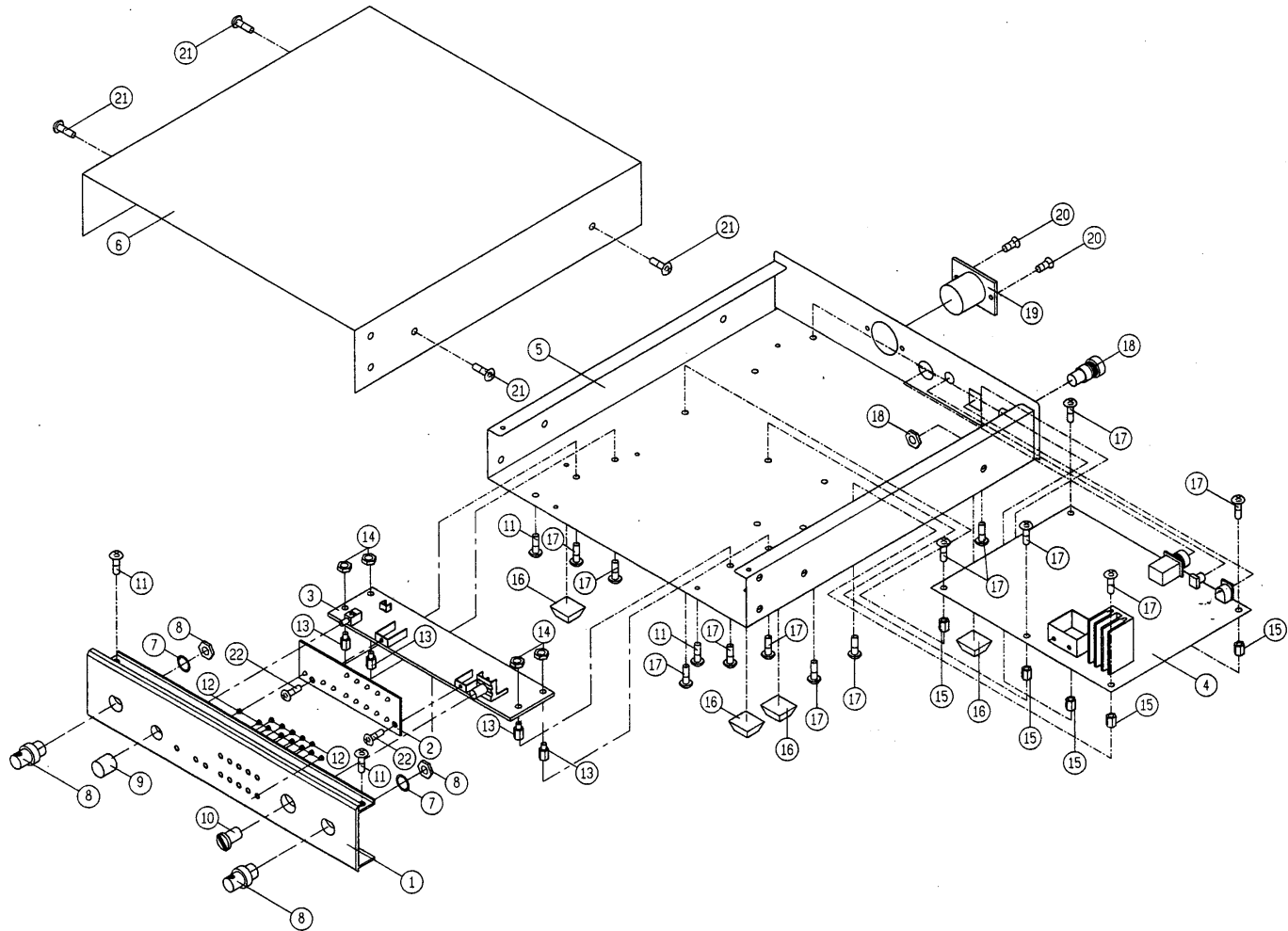

L2000-SD Block Diagram

L2000-SD & TD Spare Part List

PARTS AVAILABLE UP TO TODAY (DECEMBER 2001)

277353	L2000-SD OWNER'S MANUAL (I-UK)
277354	L2000-TD OWNER'S MANUAL (I-UK)
SKK347000	WIRELESS SYSTEM BAG
SKK888000	L2000SD-RX RECEIVER
SKK888006	L2000TD-RX RECEIVER
SKK888010	MONO JACK-JACK CABLE L=1,5MT
SKK888011	ANTENNA FOR VHF SYSTEM
SKK888012	ADAPTER "D41WI120300-12/1" 230V VOUT=12VDC 300MA
SKK888013	ADAPTER "D41WI120300-12/1" 115V VOUT=12VDC 300MA

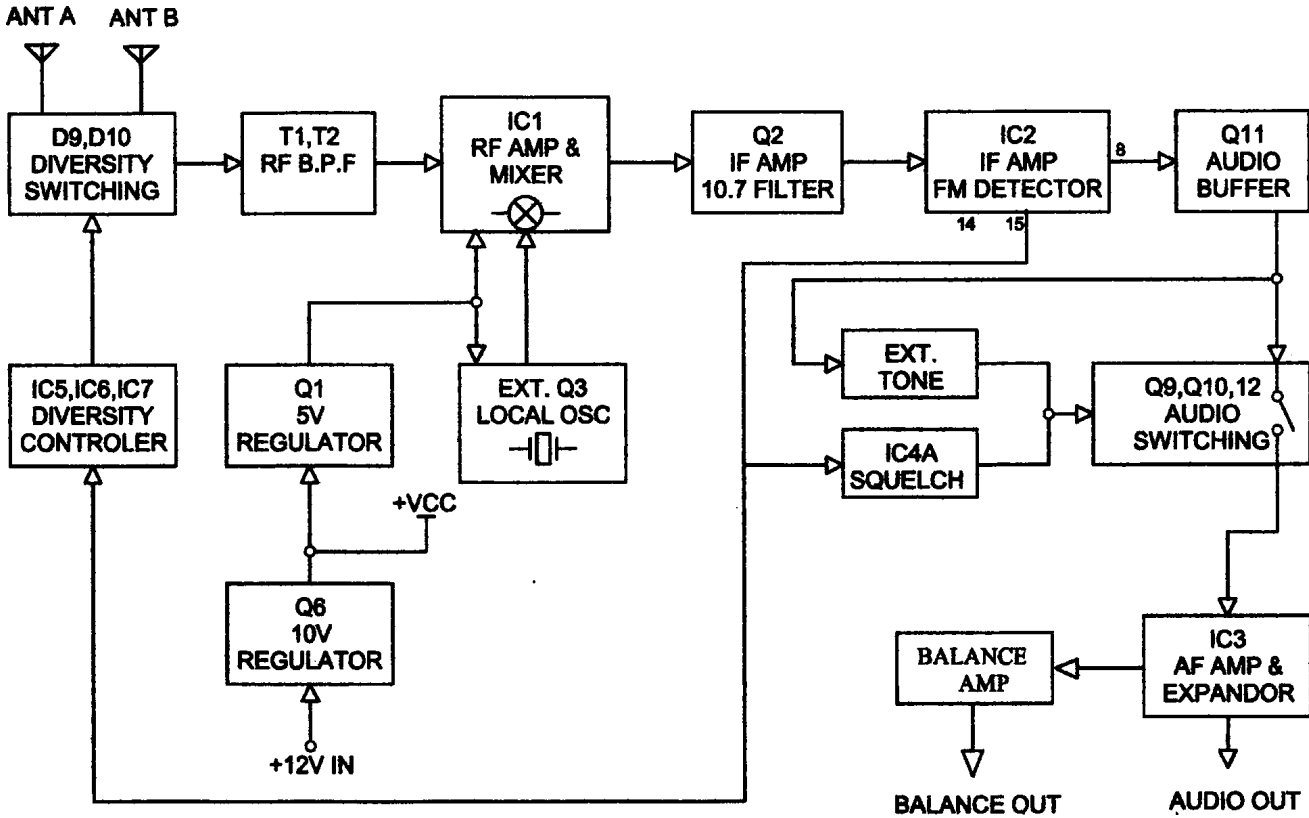

N.	FREQ.	XTAL
1	175.500MHz	62.0667MHz
2	176.300MHz	62.3333MHz
3	179.300MHz	63.3333MHz
4	181.900MHz	64.2000MHz
5	184.320MHz	65.0060MHz
6	184.540MHz	65.0800MHz
7	209.820MHz	73.5060MHz

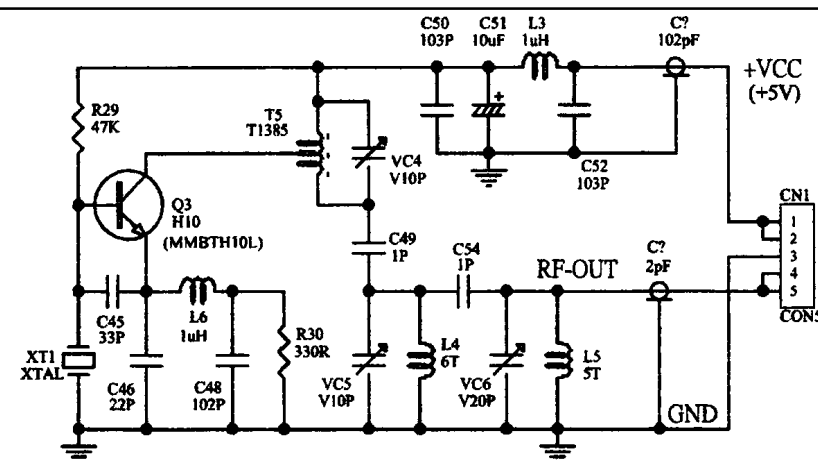

\* Freq:160-195MHz C46=33PF  
\* Freq:195-245MHz C46=22PF

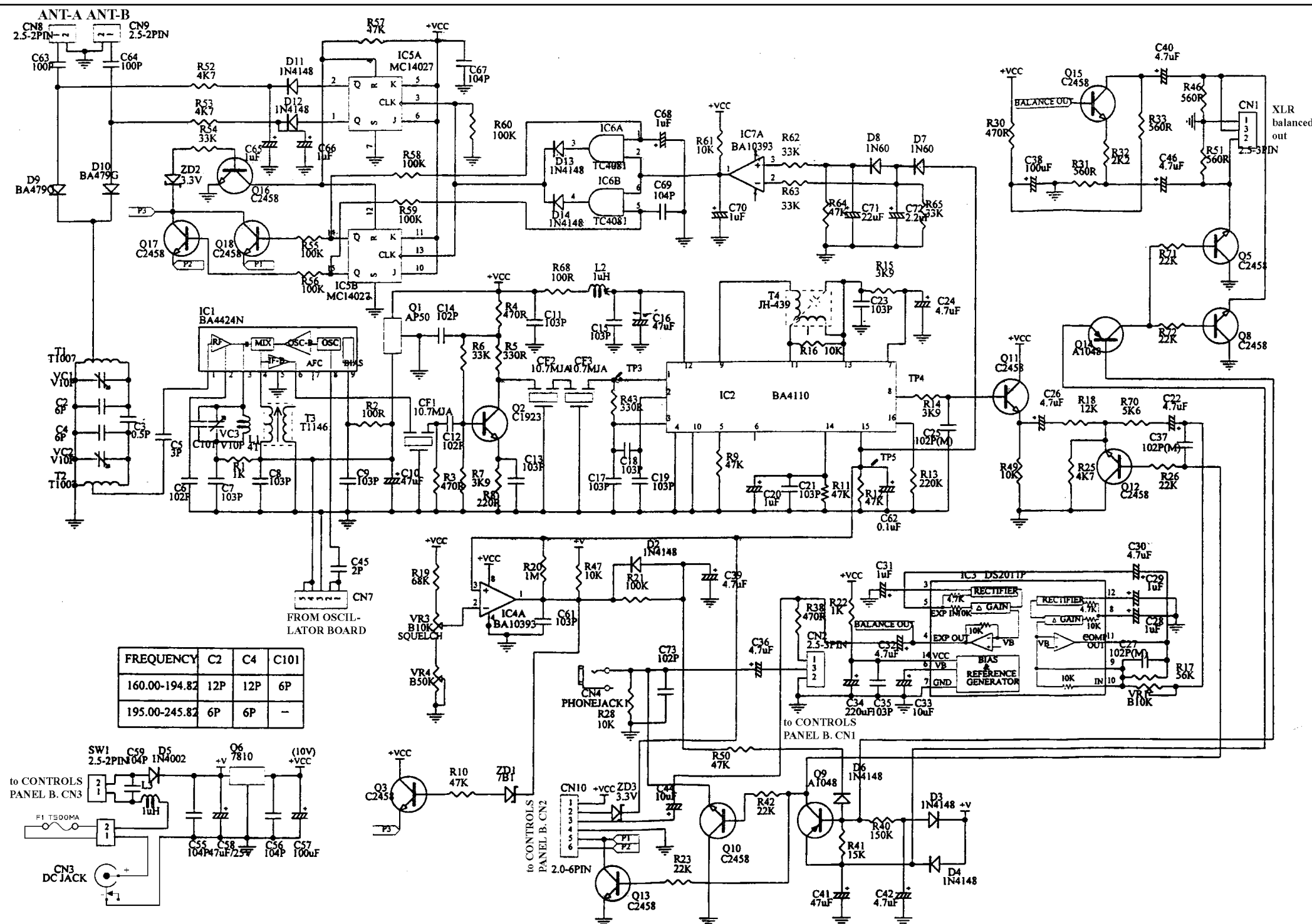
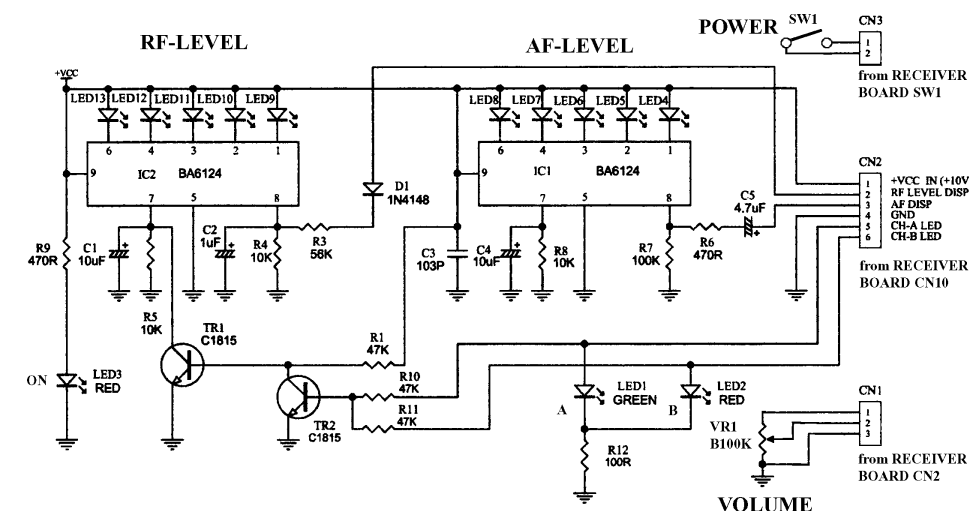

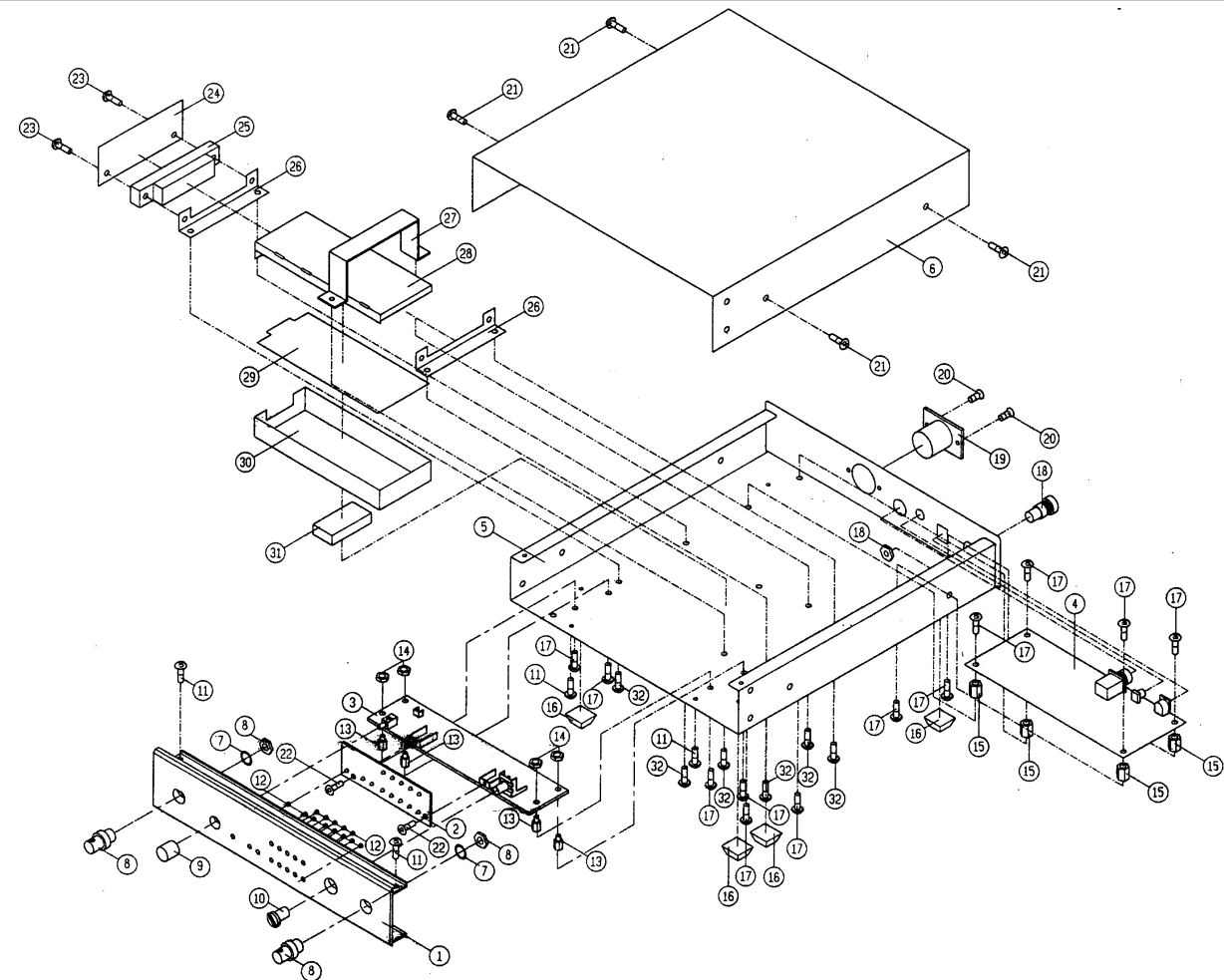

L2000-TD Block Diagram (General)

L2000-TD Block Diagram (Receiver Module)

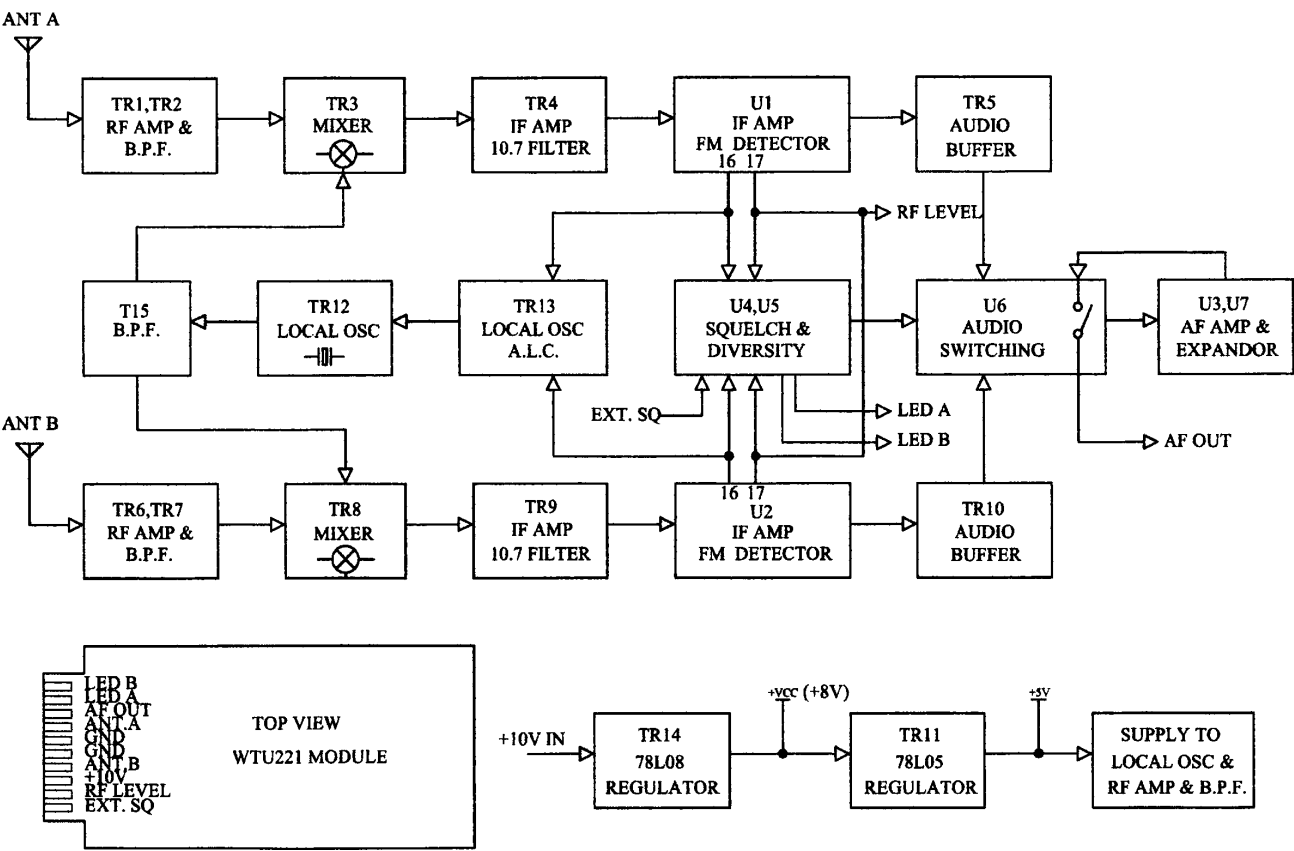
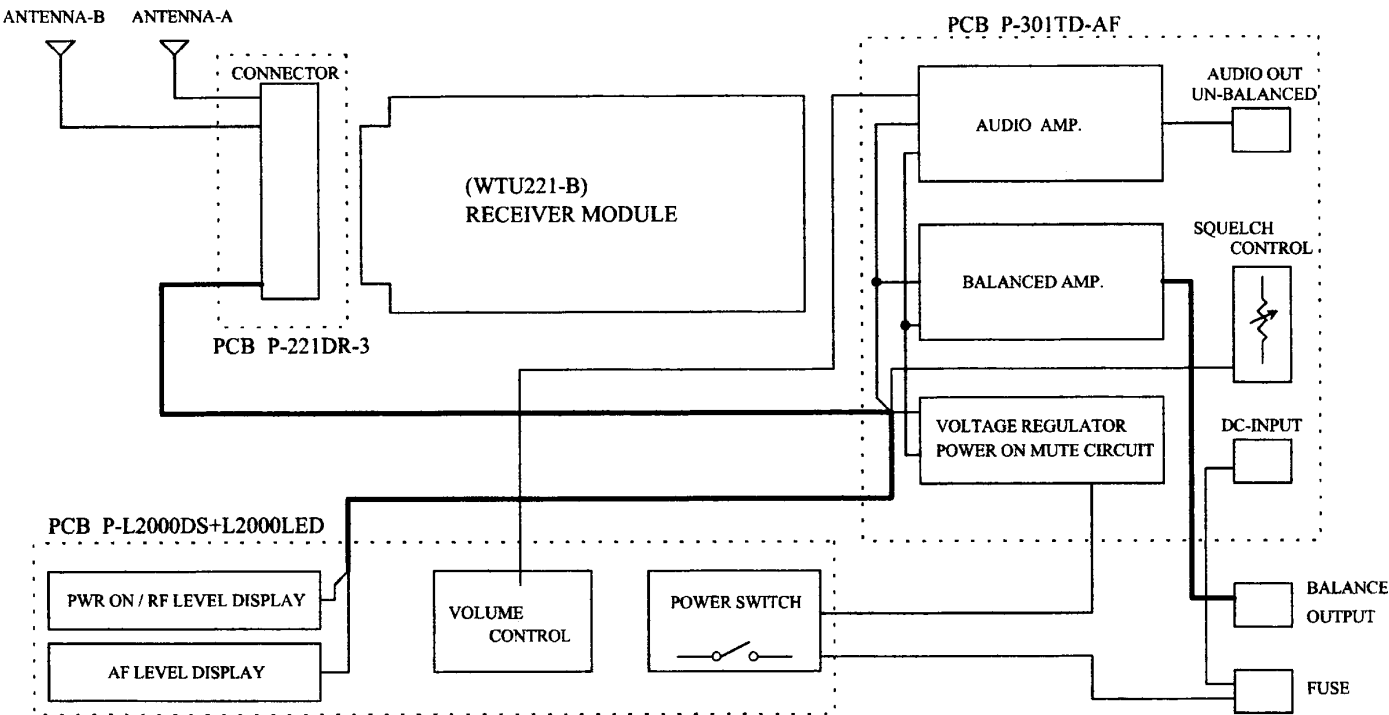



L2000-SD Schematic Diagram

